

**SCALE**  
 HORIZ: 1"=20'  
 VERT: 1"=10'

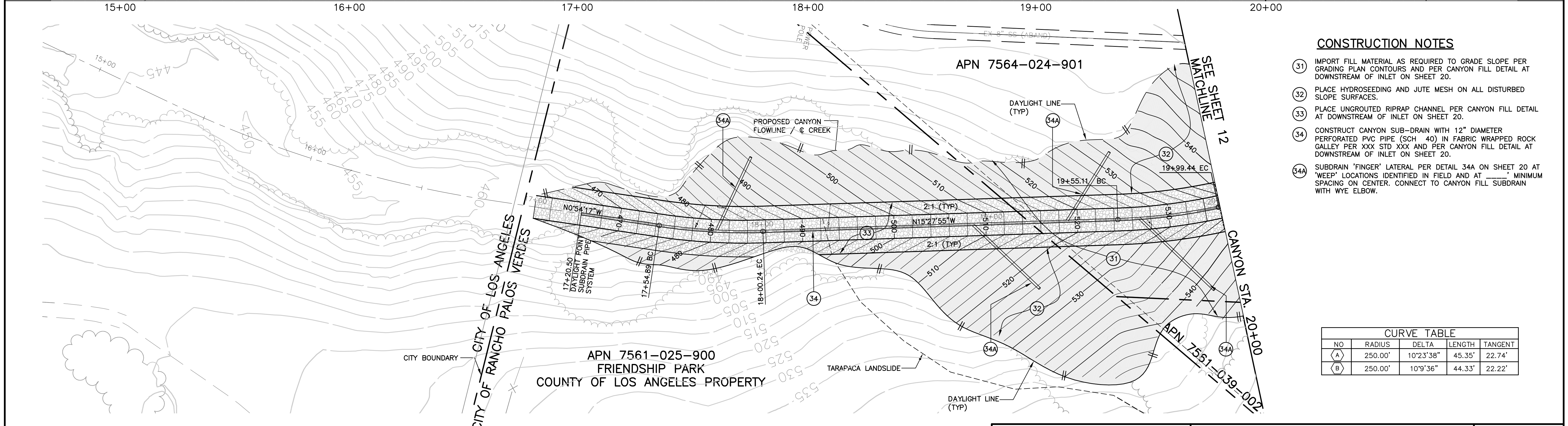

- CONSTRUCTION NOTES**
- 31 IMPORT FILL MATERIAL AS REQUIRED TO GRADE SLOPE PER GRADING PLAN CONTOURS AND PER CANYON FILL DETAIL AT DOWNSTREAM OF INLET ON SHEET 20.
  - 32 PLACE HYDROSEEDING AND JUTE MESH ON ALL DISTURBED SLOPE SURFACES.
  - 33 PLACE UNGROUTED RIPRAP CHANNEL PER CANYON FILL DETAIL AT DOWNSTREAM OF INLET ON SHEET 20.
  - 34 CONSTRUCT CANYON SUB-DRAIN WITH 12" DIAMETER PERFORATED PVC PIPE (SCH 40) IN FABRIC WRAPPED ROCK GALLEY PER XXX STD XXX AND PER CANYON FILL DETAIL AT DOWNSTREAM OF INLET ON SHEET 20.
  - 34A SUBDRAIN 'FINGER' LATERAL PER DETAIL 34A ON SHEET 20 AT 'WEEP' LOCATIONS IDENTIFIED IN FIELD AND AT \_\_\_\_\_ MINIMUM SPACING ON CENTER. CONNECT TO CANYON FILL SUBDRAIN WITH WYE ELBOW.

CURVE TABLE				
NO	RADIUS	DELTA	LENGTH	TANGENT
A	250.00'	10°23'38"	45.35'	22.74'
B	250.00'	10°9'36"	44.33'	22.22'

60% DESIGN PLANS  
 NOT FOR CONSTRUCTION  
 NOVEMBER 1, 2011

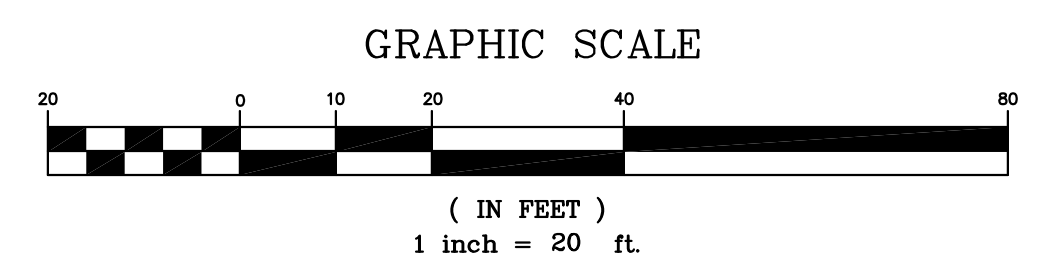

PLAN PREPARED BY:  
**Harris & Associates**  
 34 Executive Park, Suite 150  
 Irvine, CA 92614 (949) 655-3900  
 RANDALL G. BERRY RCE #44642 DATE

CITY OF RANCHO PALOS VERDES  
 \_\_\_\_\_  
 SENIOR ENGINEER DATE  
 RCE: 54924

NO.	DATE	DESCRIPTION	APPROVED
REVISIONS			

DESIGNED RGB/EGR/PL  
 DRAWN EGR/PL  
 CHECKED RGB  
 DATE OCT 11

CITY OF RANCHO PALOS VERDES

**SAN RAMON STORM DRAIN**  
**PLAN AND PROFILE**  
 GRAVITY BUTTRESS - DOWNSTREAM TERMINUS TO STA 20+00

SHEET 11 OF 31  
 SHT. 11  
 PRJ NO. XXXXX