

CONSTRUCTION NOTES

- CONTRACTOR SHALL NOT WILLFULLY PROCEED WITH CONSTRUCTION AS DESIGNED WHEN IT IS OBVIOUS THAT UNKNOWN OBSTRUCTIONS AND/OR GRADE DIFFERENCES EXIST THAT MAY HAVE NOT BEEN KNOWN DURING DESIGN. SUCH CONDITIONS SHALL BE IMMEDIATELY BROUGHT TO THE ATTENTION OF THE LANDSCAPE ARCHITECT AND THE CITY/COUNTY REP. FAILURE TO GIVE SUCH NOTIFICATION SHALL RESULT IN THE CONTRACTOR ASSUMING FULL RESPONSIBILITY FOR ALL NECESSARY REVISIONS.
- CONTRACTOR SHALL BE RESPONSIBLE FOR MAKING HIMSELF FAMILIAR WITH ALL UNDERGROUND UTILITIES, PIPES AND STRUCTURES. CONTRACTOR SHALL TAKE SOLE RESPONSIBILITY FOR COST INCURRED DUE TO DAMAGE AND REPLACEMENT OF SAID UTILITIES.
- CONTRACTOR SHALL BE RESPONSIBLE FOR ANY COORDINATION WITH OTHER SUB-CONTRACTORS AS REQUIRED TO ACCOMPLISH CONSTRUCTION OPERATIONS.
- SEE GRADING PLANS FOR VERTICAL CONTROL, WHERE APPLICABLE.
- CONTRACTOR SHALL COORDINATE IRRIGATION SLEEVE LOCATIONS UNDER PAVED AREAS AS REQUIRED. REFER TO IRRIGATION PLANS.
- PRIOR TO PLACING CONCRETE OR AC, THE CONTRACTOR SHALL SUFFICIENTLY COMPACT THE SUBGRADE AND PROVIDE SUBSURFACE PREPARATION PER SPECIFICATIONS.
- CONCRETE/HARDSCAPE SURFACES SHALL BE FORMED WITH LONG, SMOOTH GRADIENTS TO REDUCE DIPS, ABRUPT CHANGES AND SHARP TRANSITIONS.
- ALL CURVILINEAR WALKS, CURBS, HEADERBOARDS, AND WALLS SHALL HAVE A CONTINUOUS SMOOTH CURVE WHERE APPLICABLE. ALL FORMS MUST BE INSPECTED AND APPROVED PRIOR TO BEGINNING THAT PHASE OF WORK.
- UNLESS OTHERWISE SHOWN, ALL WALKS SHALL BE 3-1/2" THICK NATURAL COLOR WITH A MEDIUM BROOM FINISH. INSTALL EXPANSION JOINTS PER PLAN.
- IF IN THE FIELD, SCALED DIMENSIONS CONFLICT WITH WRITTEN GRADES, AND/OR DIMENSIONS, THE WRITTEN INFORMATION SHALL TAKE PRECEDENCE.

CONSTRUCTION LEGEND

- | | | |
|--|----------|----------|
| 1. INSTALL 6" DEEP SHREDDED WOOD MULCH. | 9 C.Y. | BID ALT. |
| 2. DEMOLISH EXIST. HEADER AND SPLICE NEW HEADER INTO MAIN PATH HEADER. | | |
| 3. CONSTRUCT TOT-LOT CURB PER DETAIL A, 1 SHEET 3. | 190 L.F. | BASE BID |
| 4. INSTALL NEW TRASH RECEPTACLE POST W/ 55 GAL. TRASH CONTAINER. PAINT W/ TWO COATS FOREST GREEN GLOSS ENAMEL. | 1 EA. | BID ALT. |
| 5. INSTALL BENCH TIMBER FORM 2014-S (14) 43-9276. | 2 EA. | BID ALT. |
| 6. CONSTRUCT PICNIC PAD PER DETAIL D SHEET 3 - CONSTRUCT 4' WIDE DECOMPOSED GRANITE ACCESS PATH @ H.C. PICNIC TABLE. | 1 EA. | BID ALT. |
| 7. INSTALL PLAY EQUIPMENT PER DETAIL A SHEET 4. | | BASE BID |
| 8. CONTRACTOR SHALL INSTALL ADDITIONAL NEW PLAY SAND AND REMOVE ANY DELETERIOUS MATERIAL FROM EXIST. PLAY SAND. | 100 C.Y. | BID ALT. |
| 9. CONSTRUCT TOT-LOT CURB PER DETAIL A, 1 SHEET 3. | 150 L.F. | BID ALT. |
| 10. INSTALL RAMP TO RUBBERIZED PLAY SURFACE PER DETAIL B SHEET 3. | | BASE BID |
| 11. INSTALL LIGHTING FIXTURE PER SPECIFICATIONS HEREON. POWER HOOK-UP @ RESTROOM BUILDING. | 2 EA. | NO ALT. |
| 12. CONSTRUCT PICNIC PAD (NO BQ) REFER TO DETAIL D, SHEET 3. | 2 EA. | BID ALT. |
| 13. CONSTRUCT CURB @ PLACE CONC. CURB WALL @ MULCH AREA. | 35 L.F. | BID ALT. |
| 14. INSTALL CONC. HEADER PER DETAIL B SHEET 3. | 50 L.F. | BID ALT. |

PLANTING LEGEND

SYM.	BOTANICAL NAME	COMMON NAME	SIZE	
○	PLATANUS ACERIFOLIA 'BLOODGOOD'	LONDON PLANE TREE	15 GAL.	BID ALT.
▲	LAGERSTRÖEMIA INDICA 'CATAWBA'	CRAPEMYRTLE	24" BOX STD.	BID ALT.

LIGHTING LEGEND

SYM.	MFG.	MODEL
○	QUALITY LIGHTING	HB-20-V-HPS-250-220-DBZ MOUNTED ON 3.5" DIA. X 16" STEEL POLE. INSTALL PER LOCAL CODE AND MANUFACTURERS SPECIFICATIONS.

- NOTES:
 A. CONTRACTOR SHALL ADJUST EXISTING IRRIGATION SYSTEM FOR FULL COVERAGE.
 B. CONTRACTOR SHALL PROVIDE BUBBLER IRRIGATION FOR NEW TREES INSTALLED IN MULCH AREA.

LOCATE EXCAVATED SOIL FROM FOOTING, GRADE 3:1 MAX OVERSEED W/ GRASS MIX TO MATCH EXISTING ADJUST IRRIGATION TO GRADE

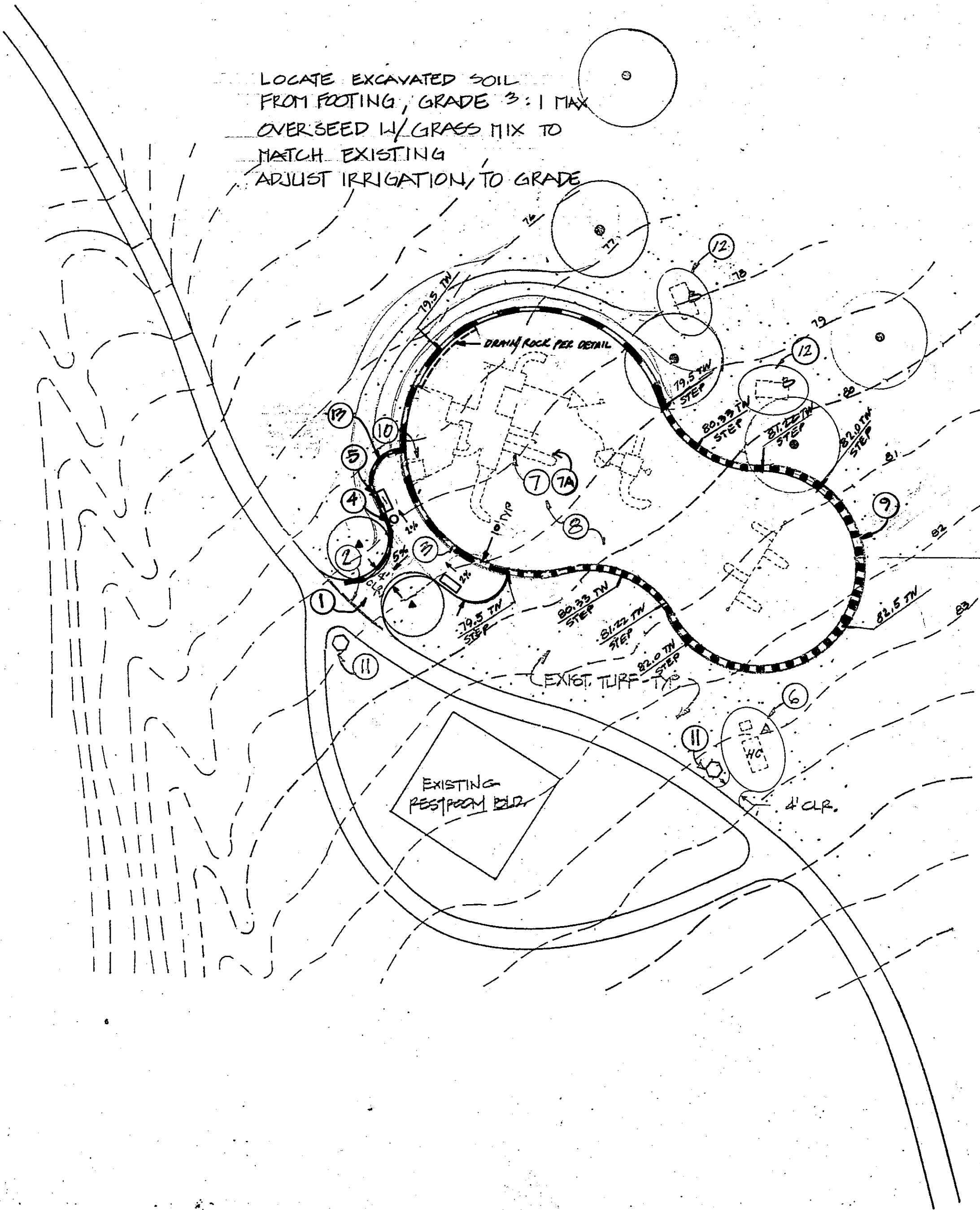

PLANTING NOTES

- CONTRACTOR SHALL NOTIFY THE LANDSCAPE ARCHITECT OF SITE CONDITIONS PRIOR TO INSTALLATION PER PLANS AND SPECIFICATIONS. CONTRACTOR SHALL NOT PROCEED WITH WORK PRIOR TO CLARIFICATION BY LANDSCAPE ARCHITECT OR CITY INSPECTOR.
- CONTRACTOR SHALL BE LIABLE FOR REMOVING AND RE-INSTALLING IRRIGATION EQUIPMENT, AND REPLANTING AREAS WHICH ARE NOT INSTALLED PER PLAN AND SPECIFICATIONS.
- REFER TO PLANTING SPECIFICATIONS FOR INSPECTION/CERTIFICATION SCHEDULE.
- IRRIGATION SYSTEM SHALL BE INSTALLED PRIOR TO PLANT MATERIALS.
- TREES AND SHRUBS SHALL BE PLANTED AFTER CONCRETE PLACEMENT, BUT NOT BEFORE IRRIGATION COVERAGE TEST NO. 1 HAS BEEN APPROVED. (SEE SPECIFICATIONS).
- PLACE TREES BETWEEN IRRIGATION HEADS WHEREVER POSSIBLE.
- LANDSCAPE CONTRACTOR SHALL TAKE FOUR (4) SOIL SAMPLES FROM THE SITE AT LOCATIONS APPROVED BY THE LANDSCAPE ARCHITECT OR OWNER'S REP. THESE SAMPLES SHALL BE TAKEN AT A DEPTH OF 12" AFTER ROUGH GRADING AND SUBMITTED TO AN APPROVED SOIL AND PLANT LABORATORY FOR AGRICULTURAL SUITABILITY TESTING. THE COST OF TESTING SHALL BE INCLUDED IN THE CONTRACTOR'S BID.
- THE RECOMMENDATIONS OF THE SOIL REPORT SHALL SUPERSEDE THE SOIL PREPARATION AND BACKFILL MIX SPECIFICATIONS (SEE SPECIFICATIONS). THE CONTRACTOR SHALL SUBMIT A COPY OF ALL SOILS REPORTS TO THE LANDSCAPE ARCHITECT PRIOR TO MODIFICATION OF THESE SPECIFICATIONS.
- SHREDDED MULCH INSTALLATION: INSTALL A 3" LAYER OF SHREDDED MULCH IN ALL SHRUB AND GROUND COVER AREAS UNLESS OTHERWISE INDICATED ON PLANS.
- CONTRACTOR IS RESPONSIBLE FOR ALL REPAIRS AND/OR REPLACEMENT OF ANY DAMAGED LANDSCAPE AREAS BEYOND THE LIMIT OF WORK THAT IS A DIRECT RESULT OF THE LANDSCAPE CONSTRUCTION AND/OR HIS SUB-CONTRACTOR. REPLACEMENT ITEMS SHALL BE EXACT DUPLICATES OF ORIGINAL WORK OR PLANTS UNLESS OTHERWISE APPROVED BY THE LANDSCAPE ARCHITECT.
- WHEREVER GROUND COVER AREAS ARE ADJACENT TO TURF INSTALL CONCRETE MOUSTRIIP OR HEADERBOARD AS INDICATED ON DRAWINGS.
- CLEAN-UP SHALL TAKE PLACE ON A DAILY BASIS UNLESS OTHERWISE APPROVED BY THE OWNER'S REPRESENTATIVE.
- WEED ABATEMENT: AFTER EARTHWORK, INSTALLATION OF IRRIGATION SYSTEM, AND SOIL PREPARATION, BUT PRIOR TO PLANTING, PERFORM WEED ABATEMENT PROGRAM TO ALL PLANTING AREAS AS FOLLOWS:
 - APPLY SULFATE OF AMMONIA AT THE RATE OF 5 LBS. PER 1000 SQ. FT. TO ALL AREAS TO BE PLANTED.
 - KEEP AREA MOIST BY REGULAR IRRIGATION FOR A PERIOD OF TWO (2) WEEKS TO GERMINATE EXISTING WEED SEEDS.
 - AT THE END OF TWO WEEKS, APPLY "ROUND UP" OR EQUAL SYSTEMIC HERBICIDE. DO NOT IRRIGATE WITHIN SIX (6) HOURS AFTER APPLICATION. REFER TO MFG. SPECIFICATIONS FOR PERIOD OF TIME REQUIRED FROM TIME OF APPLICATION TO TIME OF PLANTING. AFTER COMPLETE WEED KILL, REMOVE ALL WEED RESIDUE AND TOP GROWTH AND DISPOSE OF IN A LEGAL MANNER.

ALTERNATIVE METHODS OF WEED KILL MAY BE VAPAM OR METHYL BROMIDE APPLIED BY A STATE OF CALIFORNIA LICENSED APPLICATOR
 ALL HERBICIDES SHALL BE APPLIED ONLY BY A CALIFORNIA LICENSED APPLICATOR. NO HERBICIDES SHALL BE APPLIED WITHOUT FIRST OBTAINING WRITTEN APPROVAL FROM THE CITY INSPECTOR.
- CONTRACTOR SHALL BE RESPONSIBLE FOR THE INSTALLATION OF ALL PLANT MATERIAL INDICATED ON PLANS. QUANTITIES INDICATED ON PLAN ARE FOR ESTIMATION PURPOSES ONLY.

SMITHGALL ASSOCIATES INC.
 LANDSCAPE ARCHITECTS

23426 MADRO SUITE 200
 HESLER VIEJA, CA 91351
 TELEPHONE 714.832.5519
 FACSIMILE 714.837.4992

CITY OF RANCHO PALOS VERDES

EASTVIEW PARK TOT LOT RENOVATION FOR THE CITY OF RANCHO PALOS VERDES, CA

Scale: 1"=20'
 Drawn: M.S.
 Designed:
 Checked:
 Date: JULY 10, 1995
 Job No. 950266-07

Approvals
 Name/Title: [Signature]
 Date: 11-1-95
 PUBLIC WORKS DIRECTOR

Revisions
 Date

Sheet Title
CONSTRUCTION PLAN

Sheet **2**
 of 5

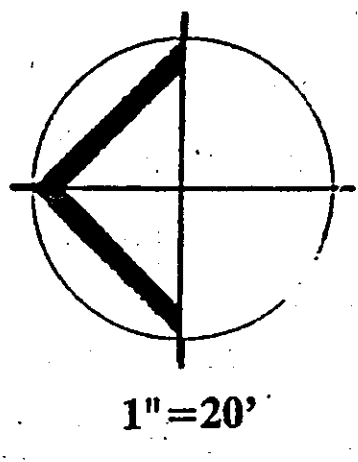

Landscape Construction 2 of 5
 Eastview Park Tot Lot Renovation
 MANAGER EPH2A
 BASH FILE CORP. IRVINE, CA