

1. test
2. approval
3. work
4. observation
5. masonry
6. hardware
7. barrier
8. metal
9. door
10. scratch

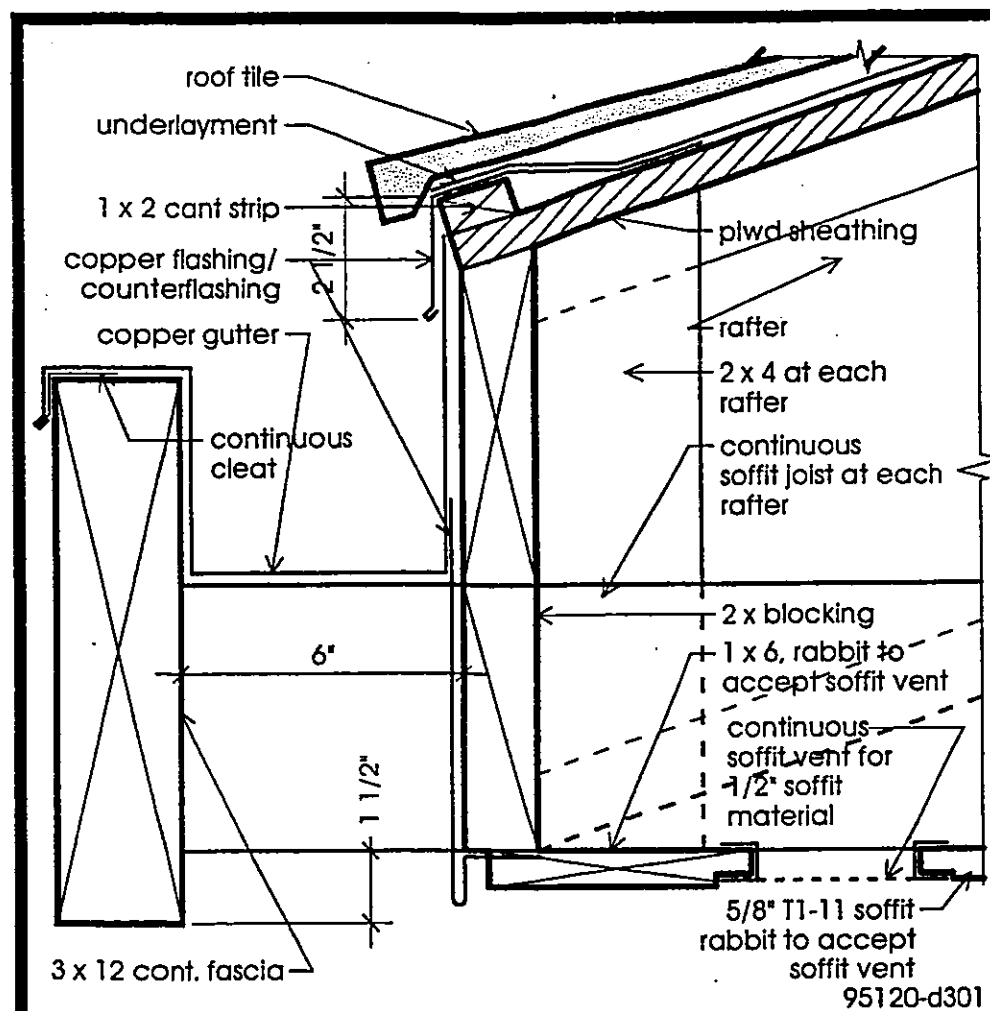

**TYPICAL EAVE** Scale: 3" = 1'-0" 1

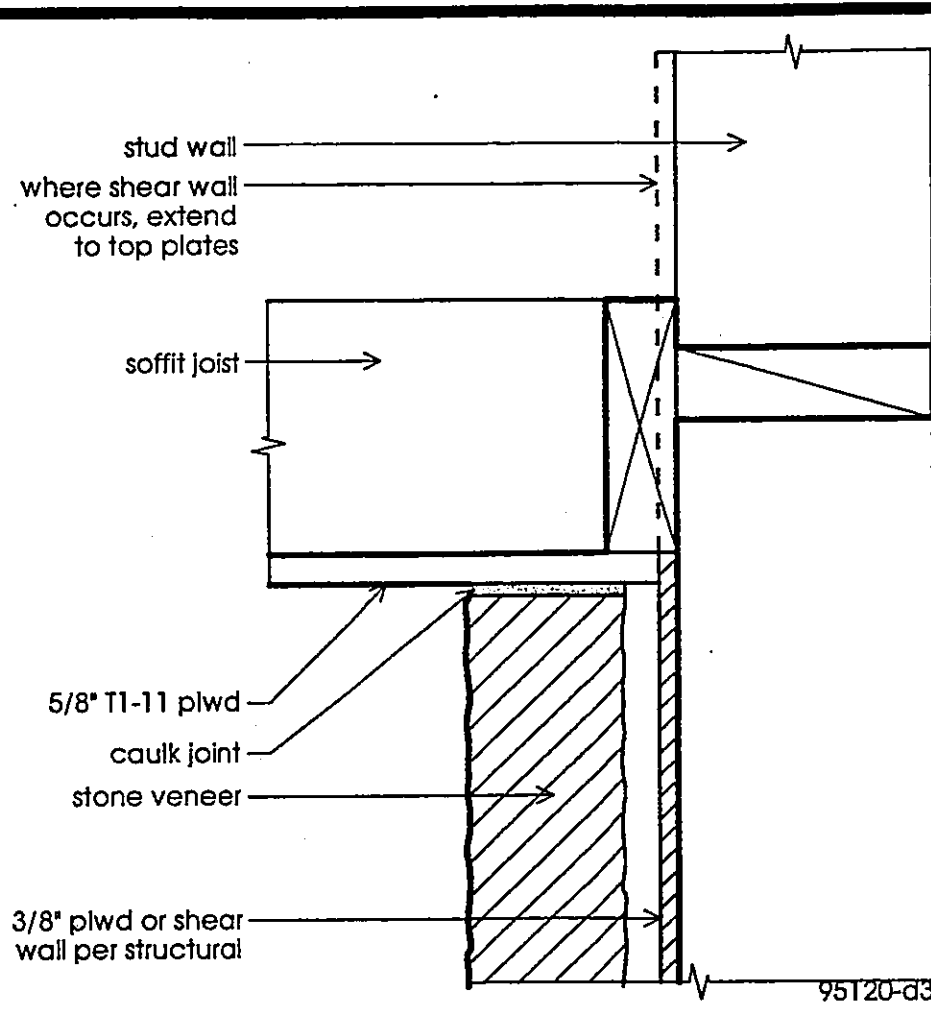

**SOFFIT AT VENEER** Scale: 3" = 1'-0" 2

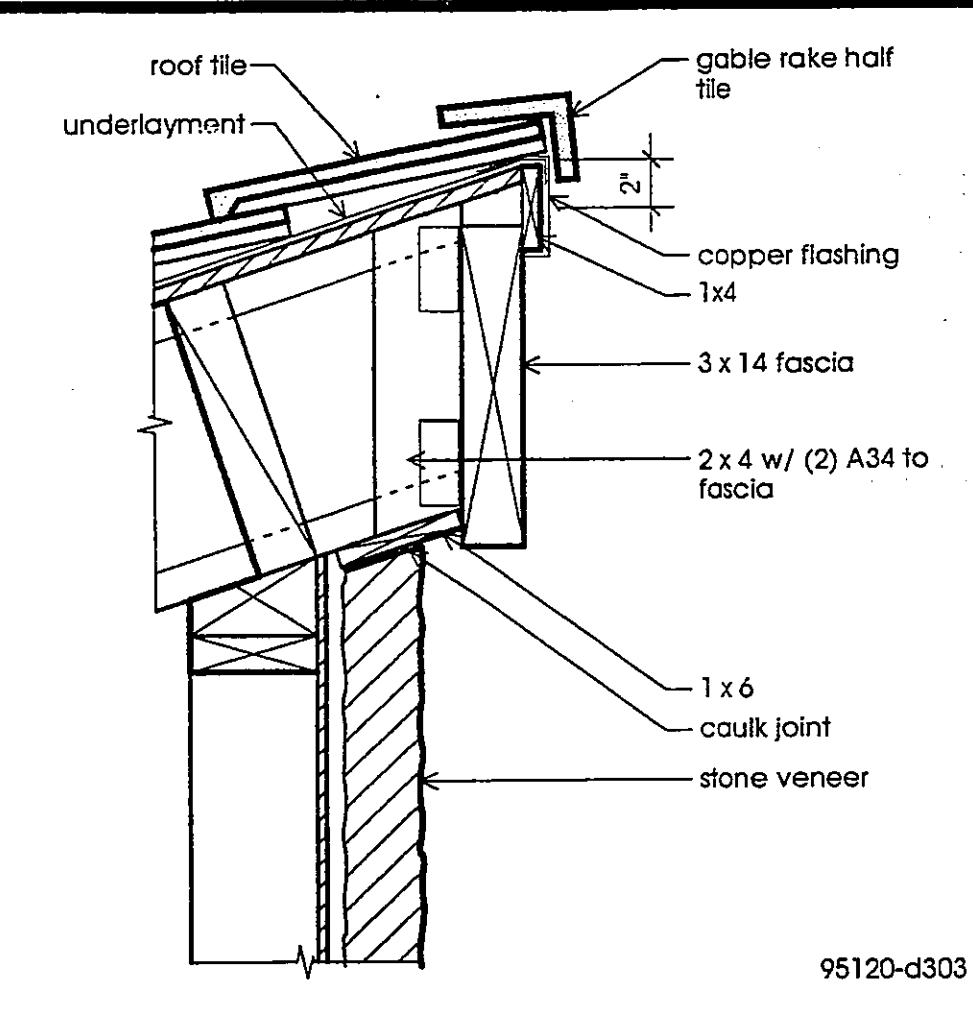

**RAKE AT VENEER** Scale: 1 1/2" = 1'-0" 3

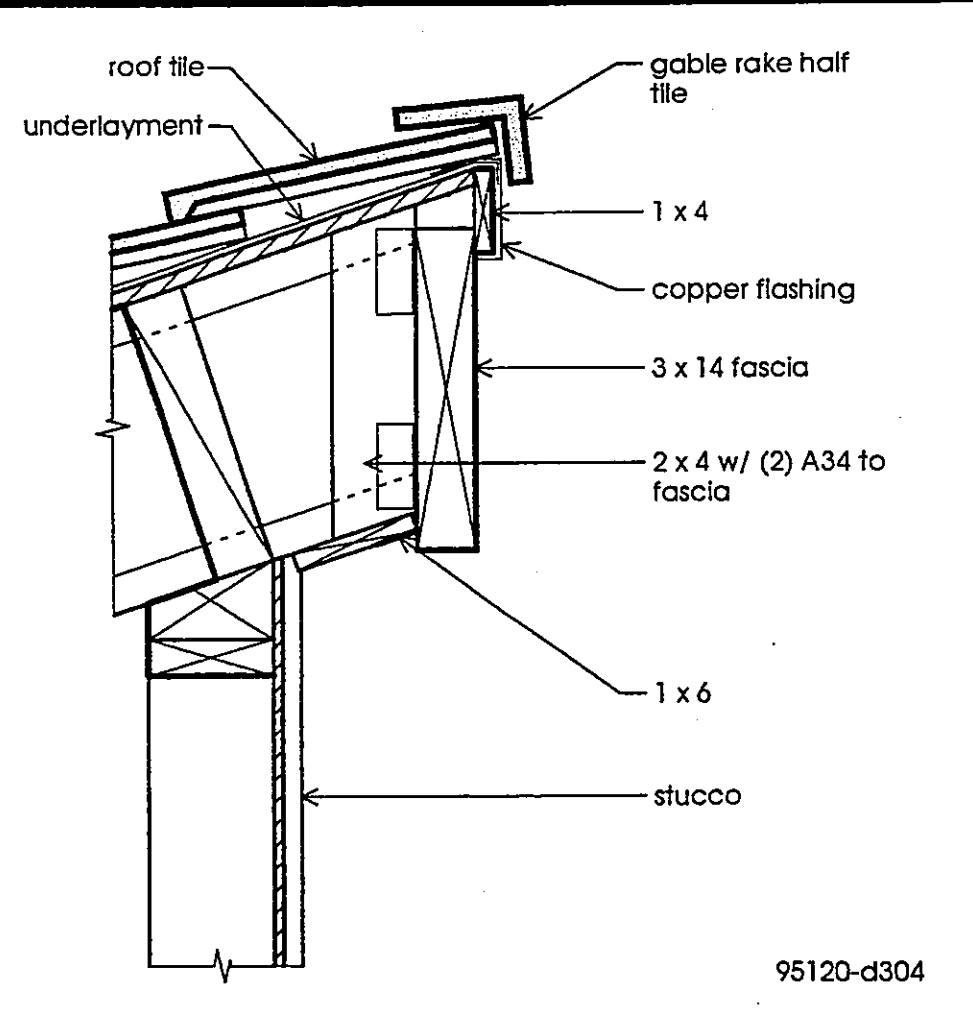

**RAKE AT STUCCO** Scale: 1 1/2" = 1'-0" 4

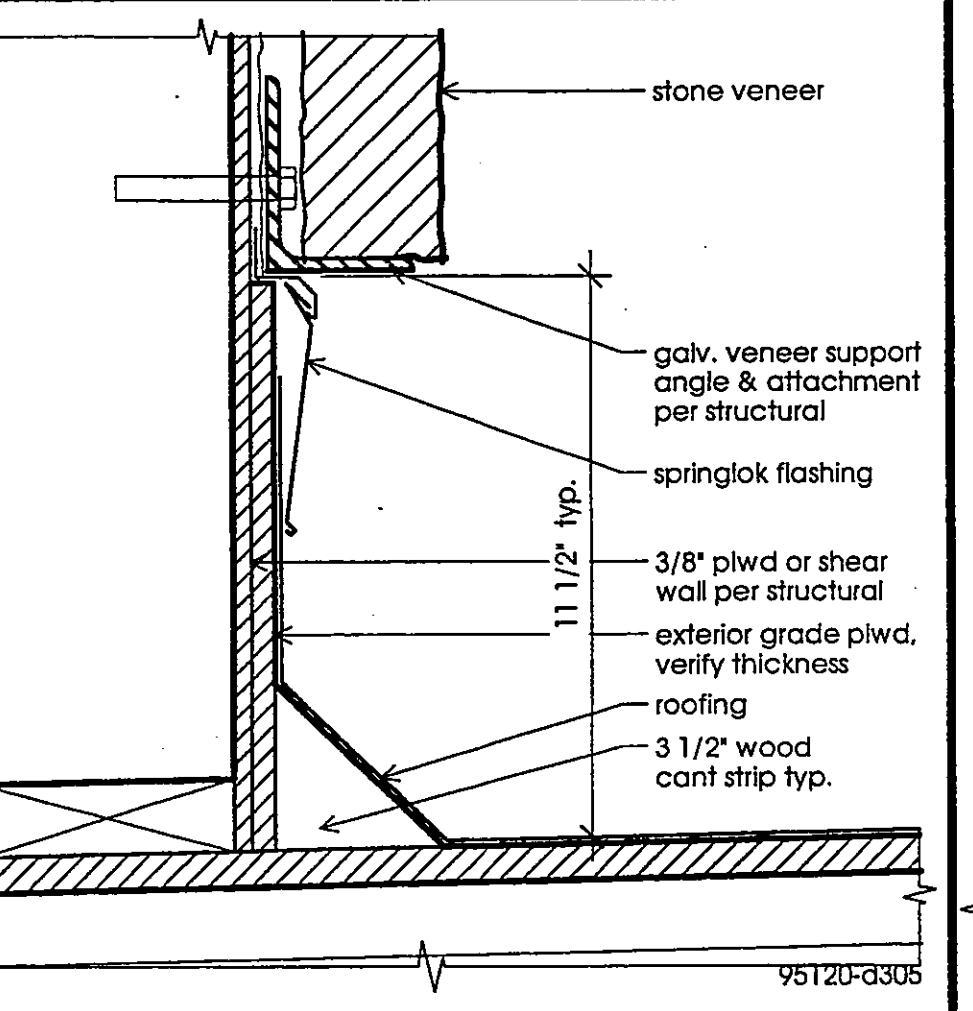

**VENEER AT MECH. WELL** Scale: 3" = 1'-0" 5

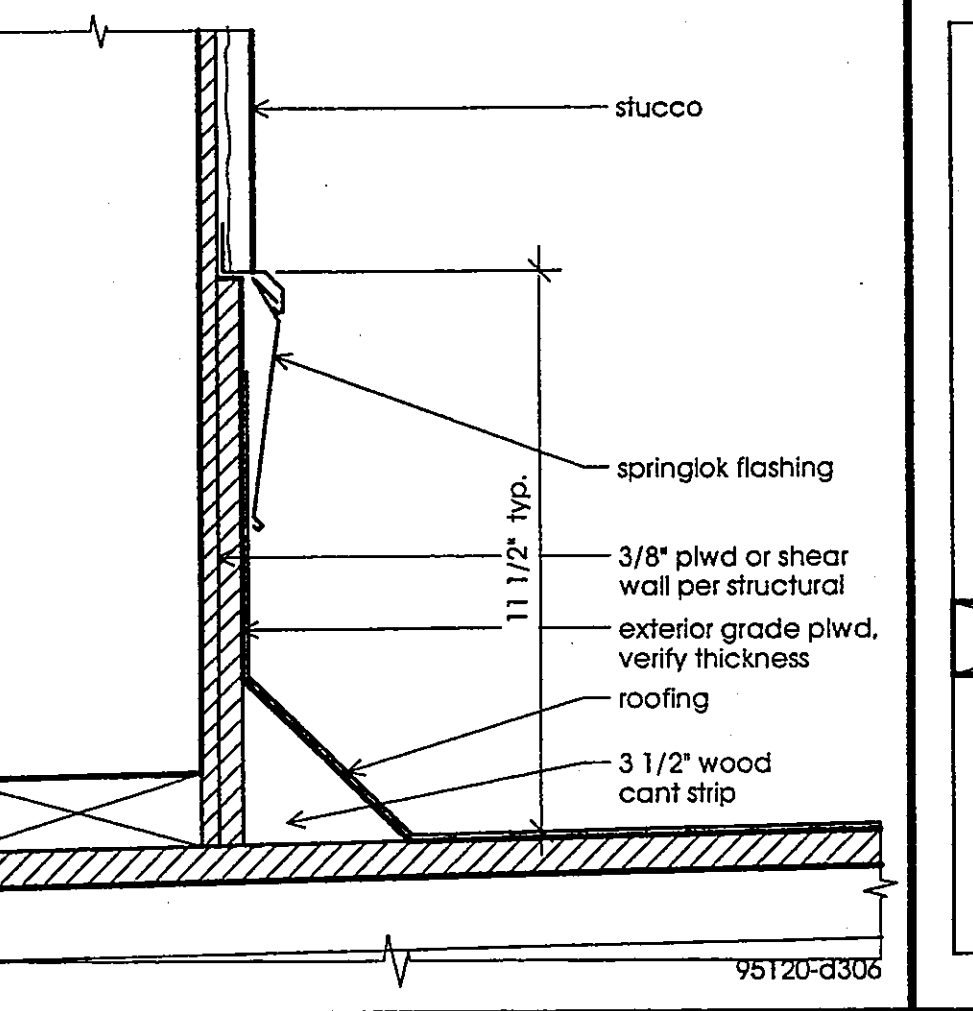

**STUCCO AT MECH. WELL** Scale: 3" = 1'-0" 6

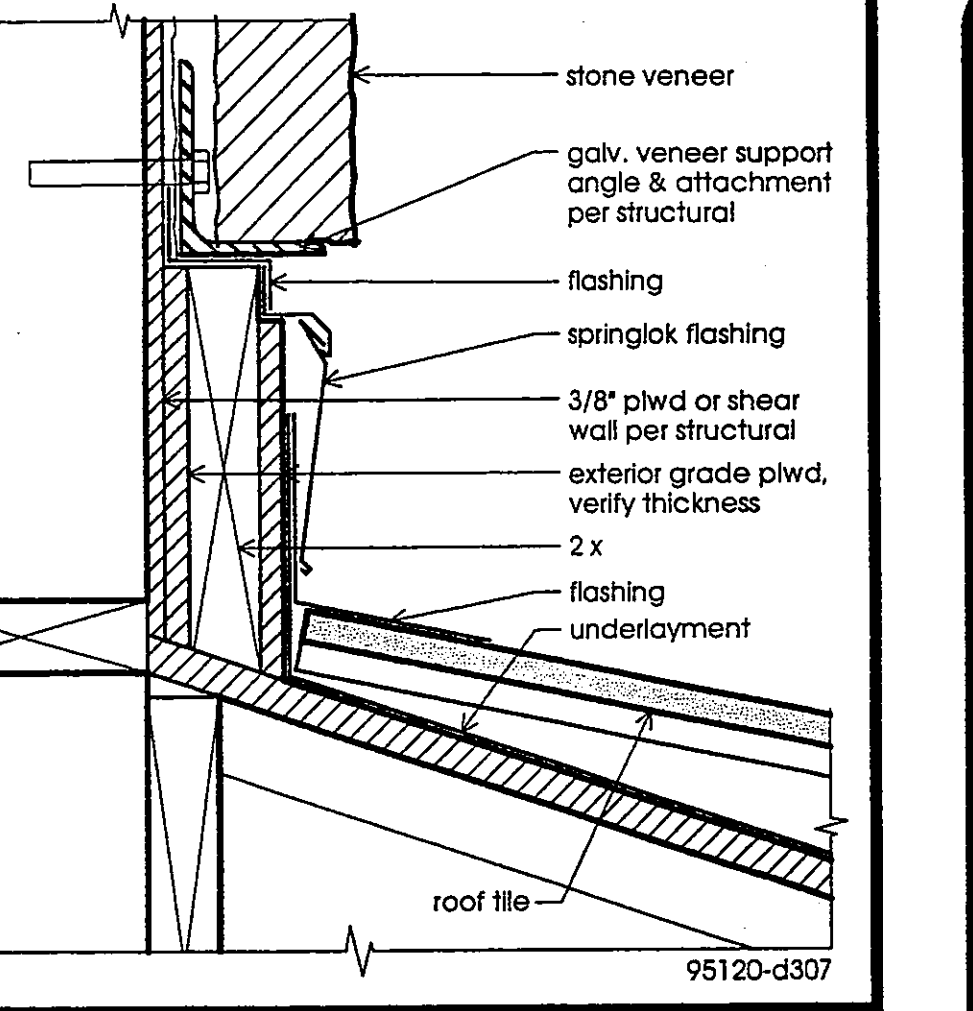

**ROOF AT WALL** Scale: 3" = 1'-0" 7

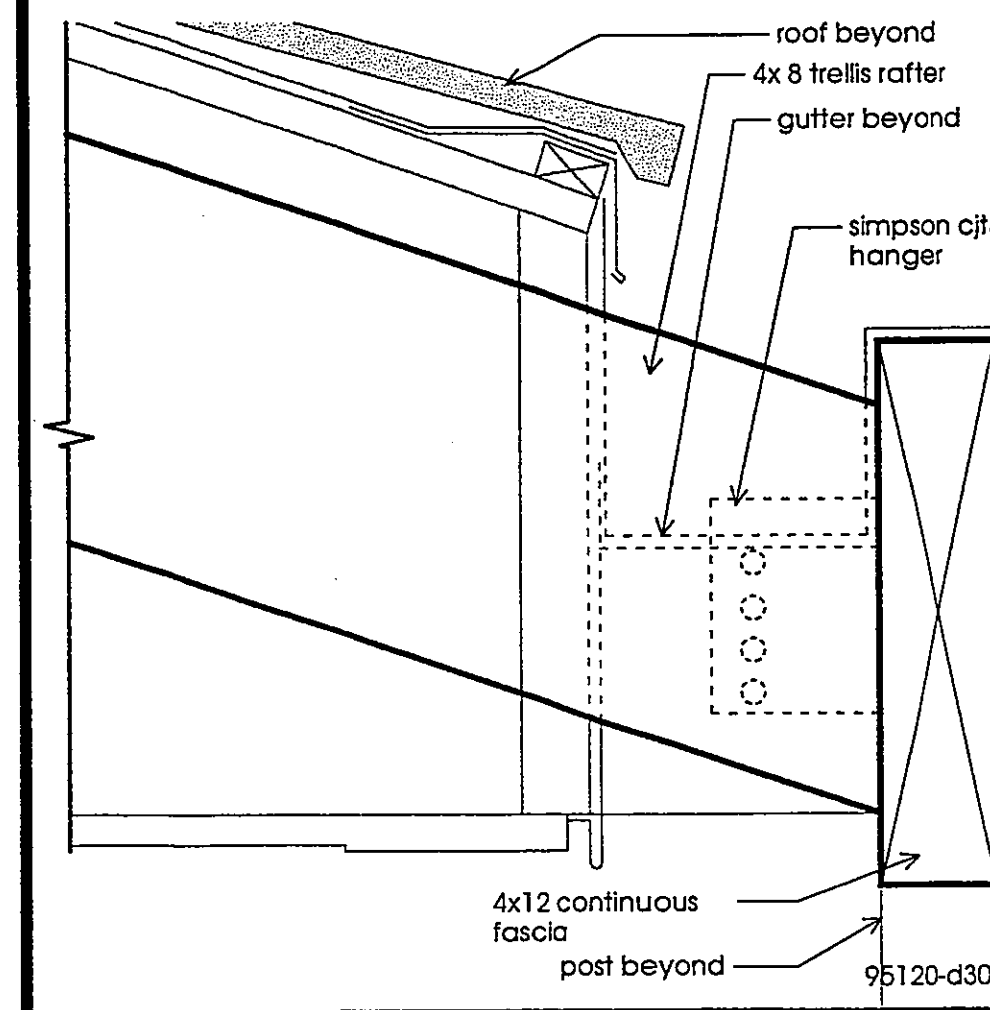

**FASCIA AT TRELLIS** Scale: 3" = 1'-0" 8

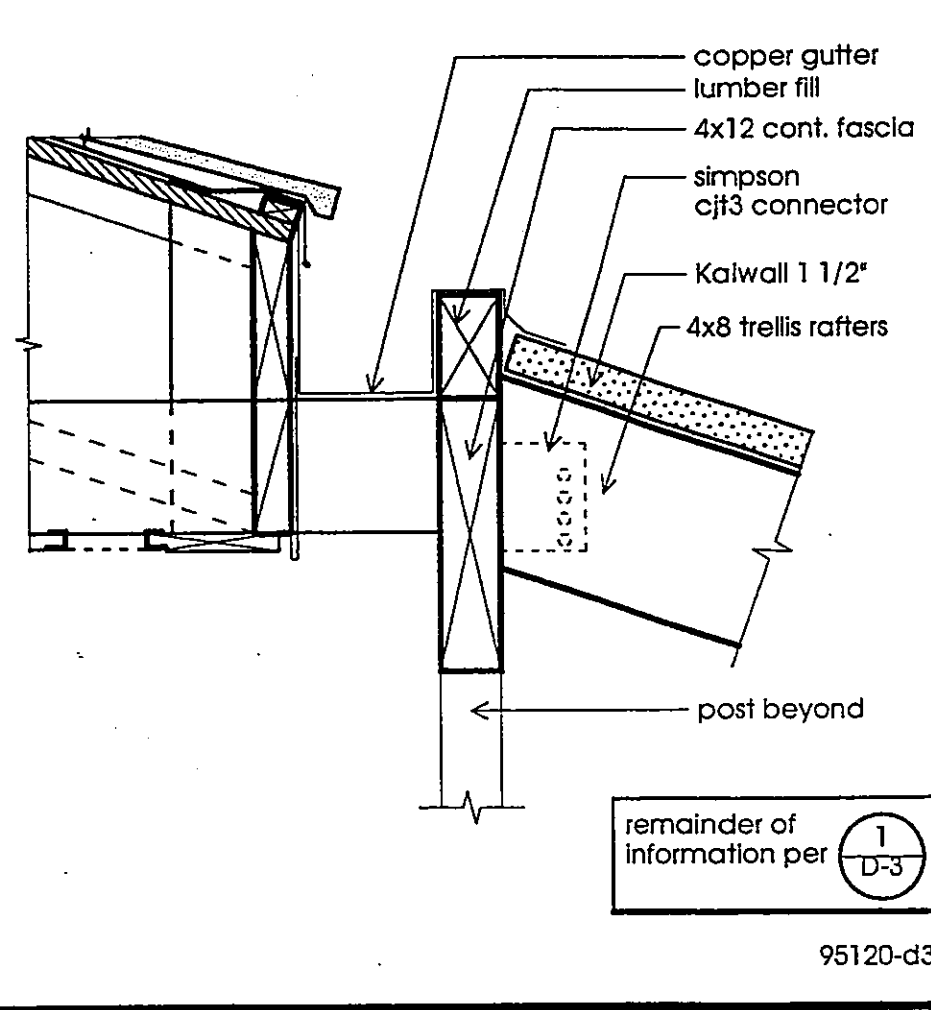

**EAVE AT TRELLIS** Scale: 1 1/2" = 1'-0" 9

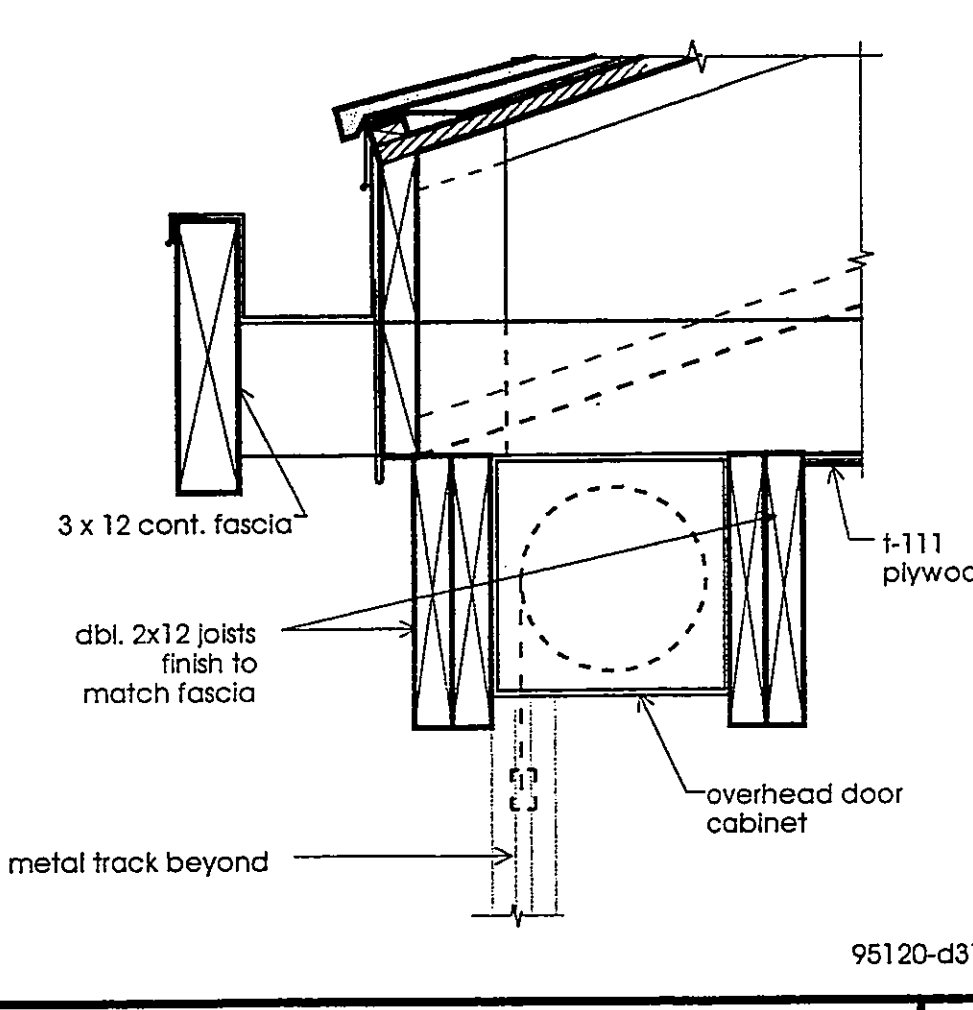

**OVERHEAD DOOR** 1 1/2" = 1'-0" 10

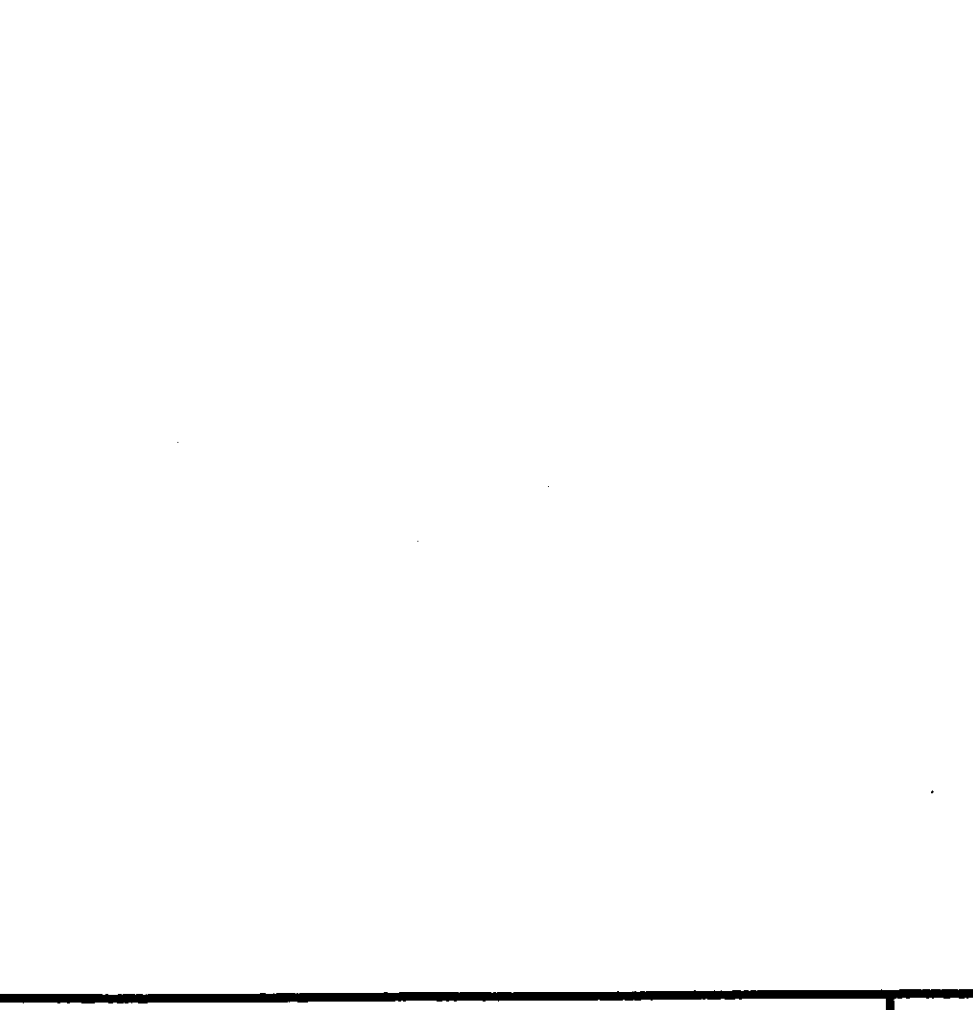

**DETAIL TITLE** Scale: 1/12" = 1'-0" 11

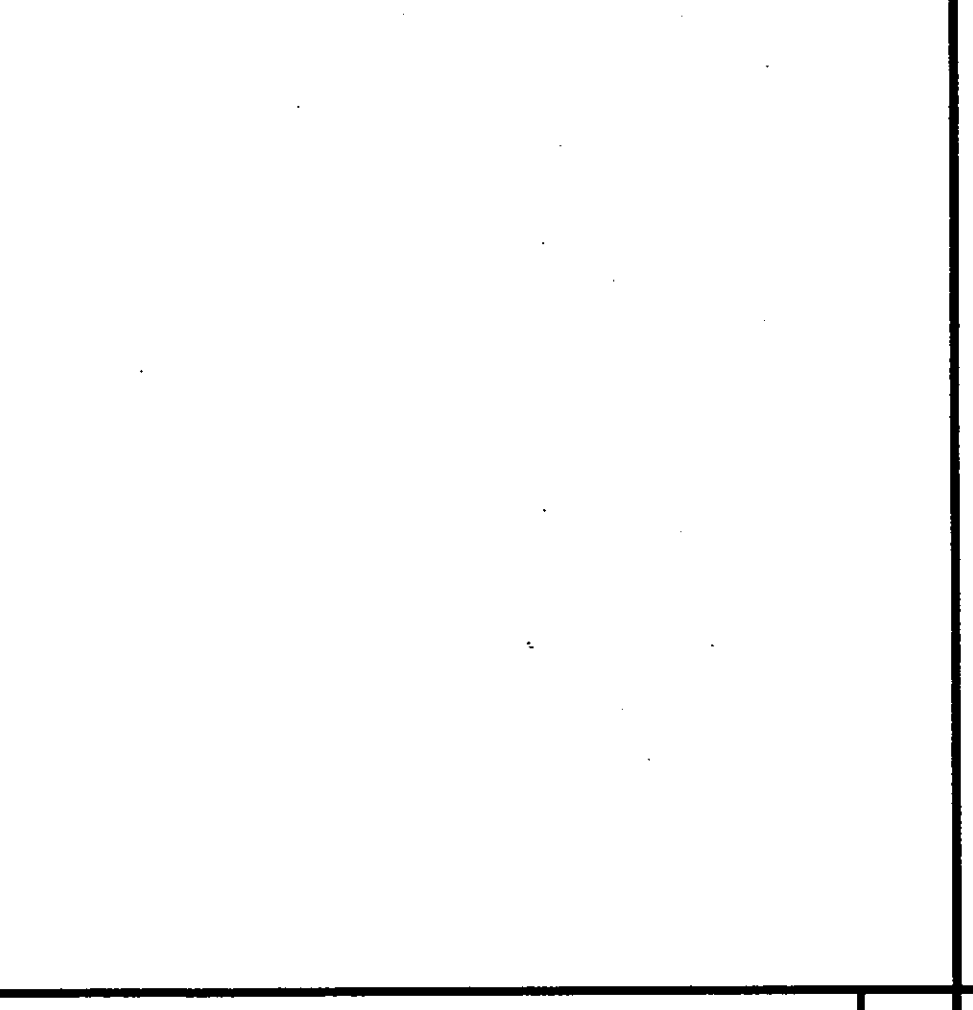

**DETAIL TITLE** Scale: 1/12" = 1'-0" 12

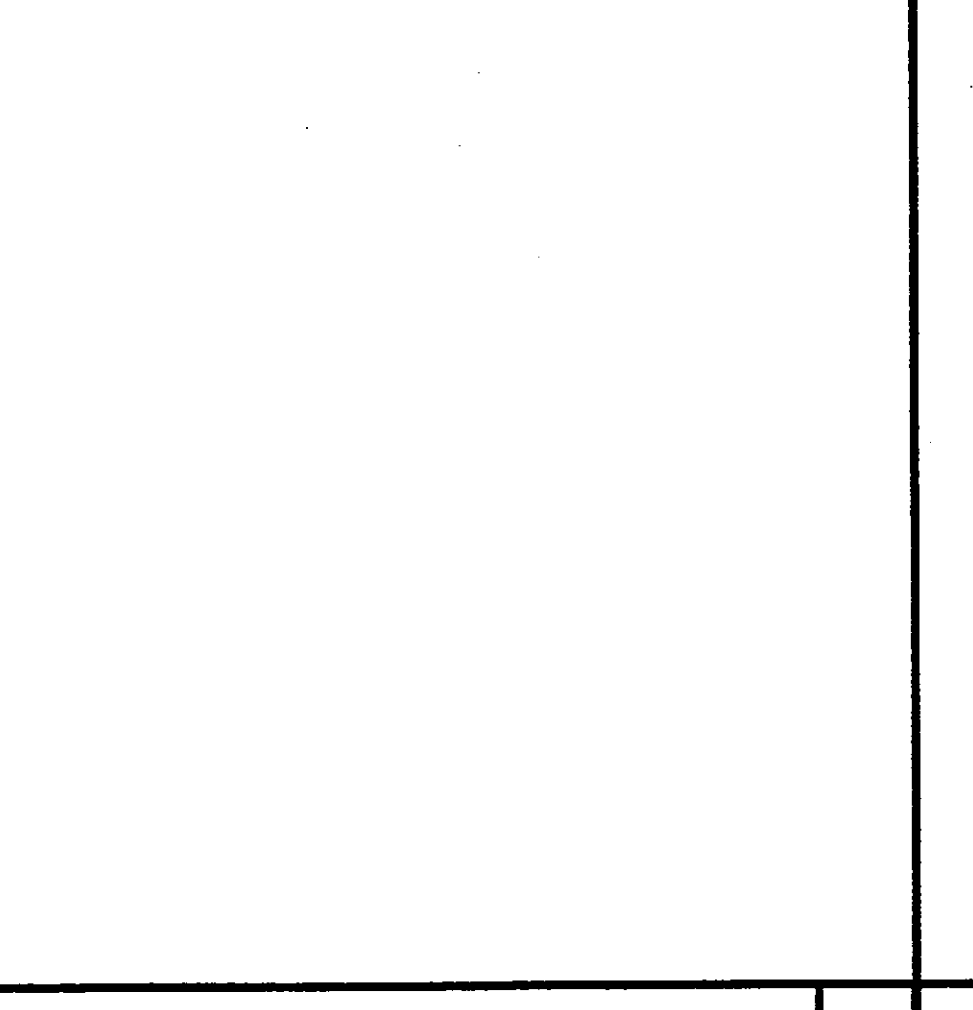

**DETAIL TITLE** Scale: 1/12" = 1'-0" 13

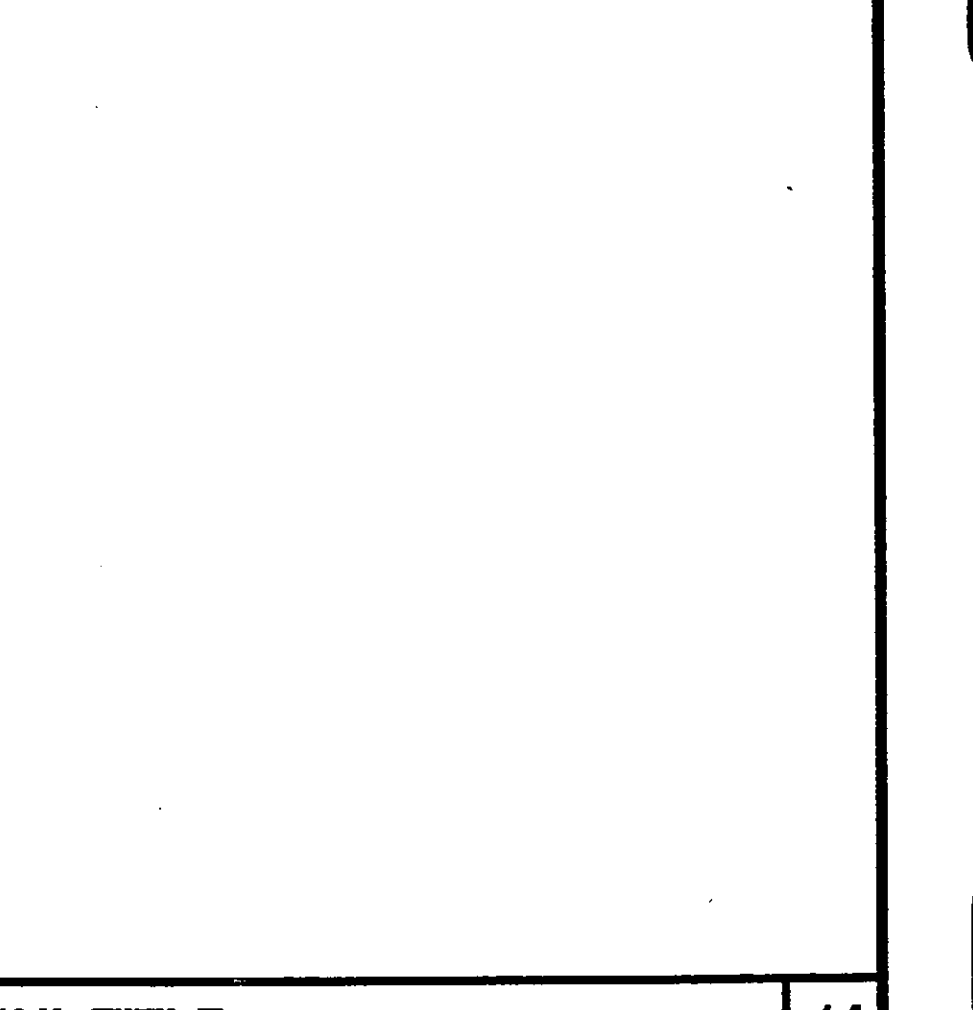

**DETAIL TITLE** Scale: 1/12" = 1'-0" 14

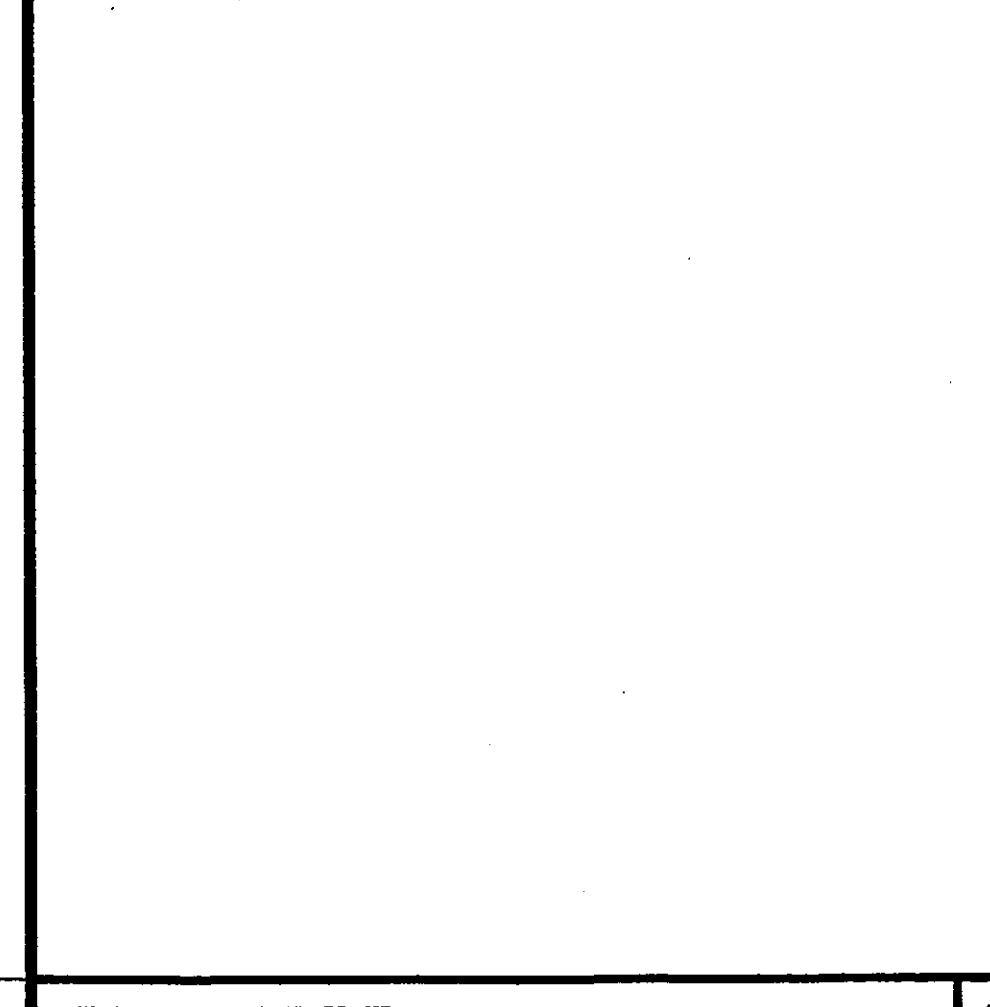

**DETAIL TITLE** Scale: 1/12" = 1'-0" 15

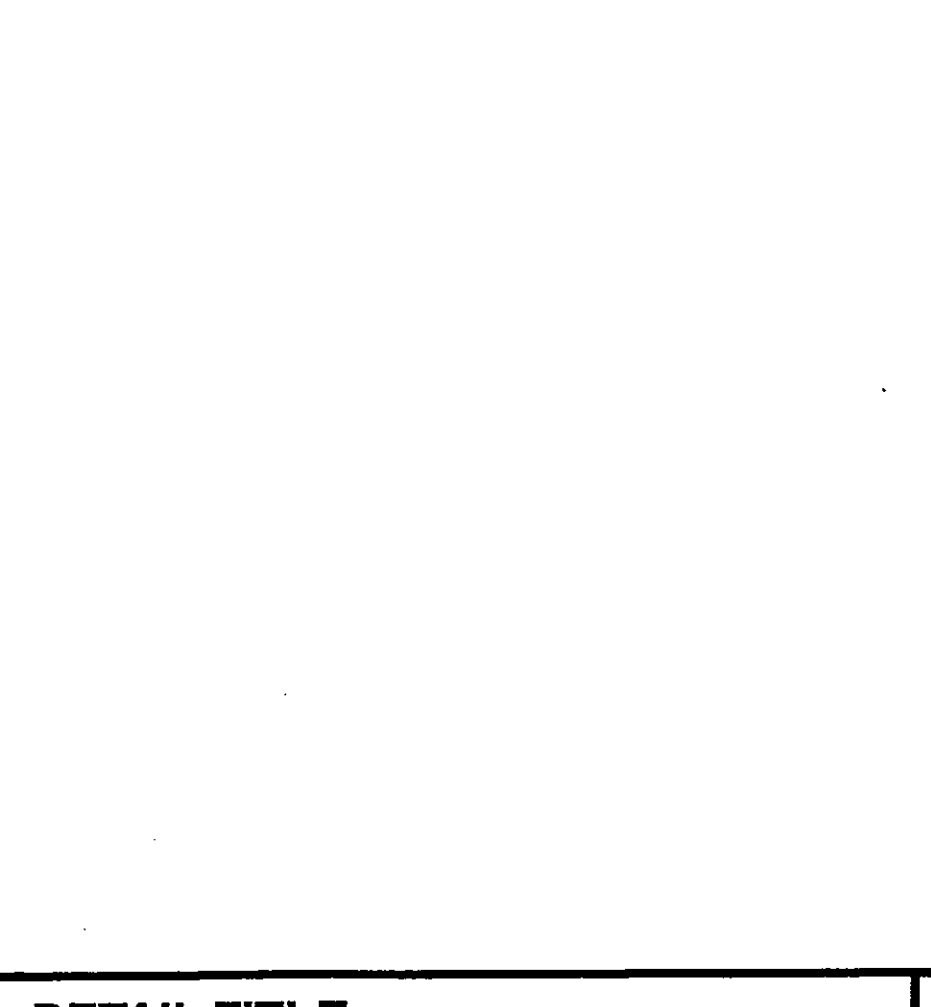

**DETAIL TITLE** Scale: 1/12" = 1'-0" 16

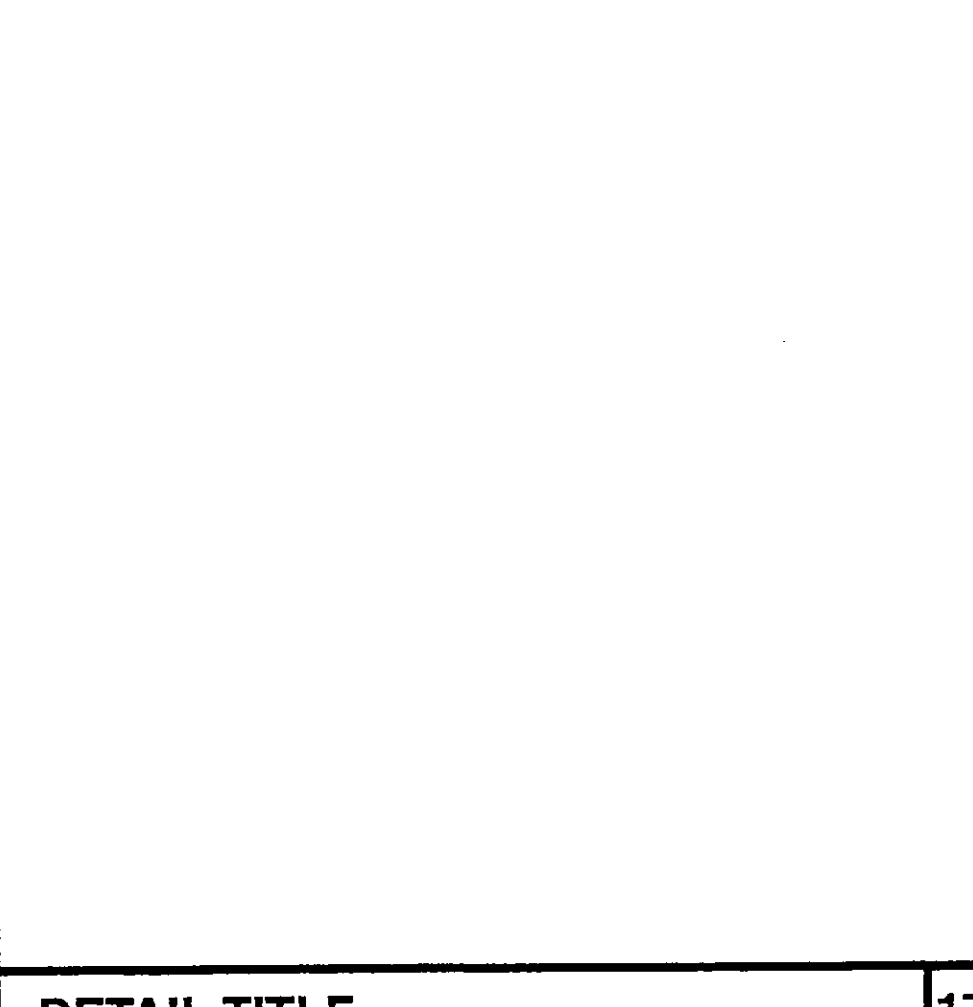

**DETAIL TITLE** Scale: 1/12" = 1'-0" 17

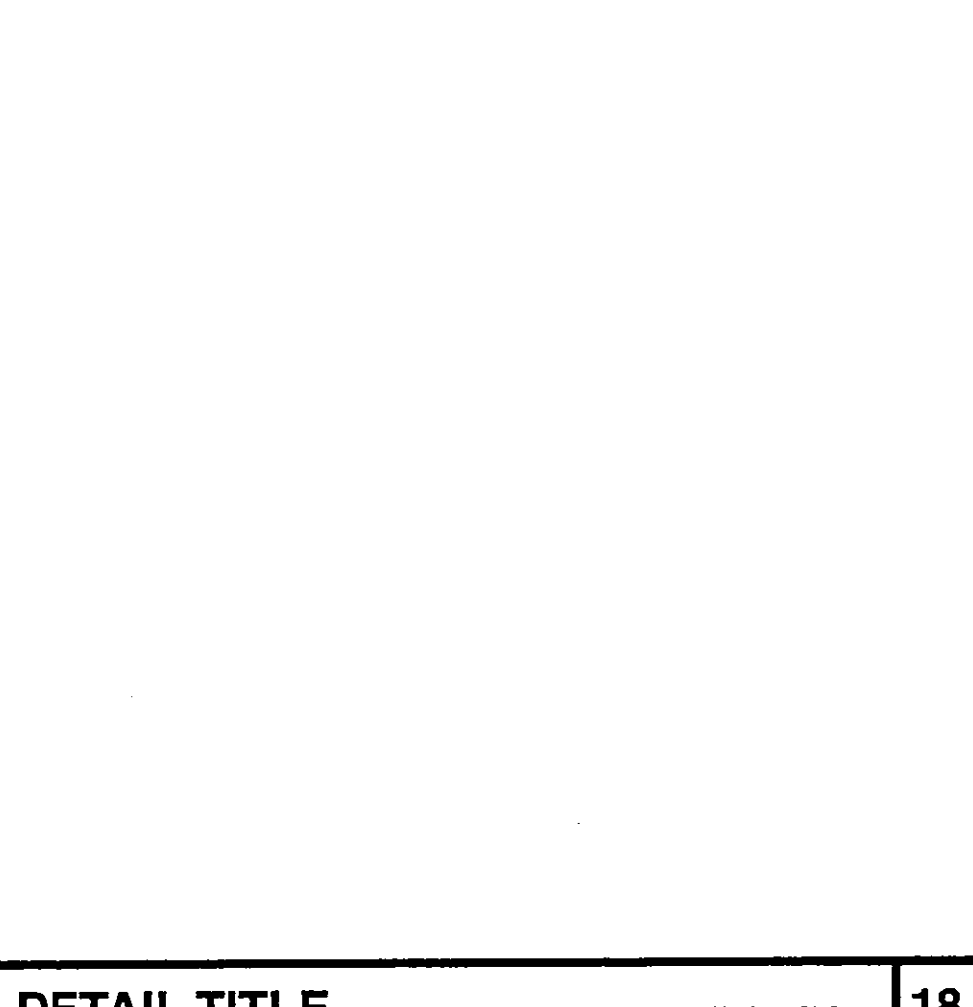

**DETAIL TITLE** Scale: 1/12" = 1'-0" 18

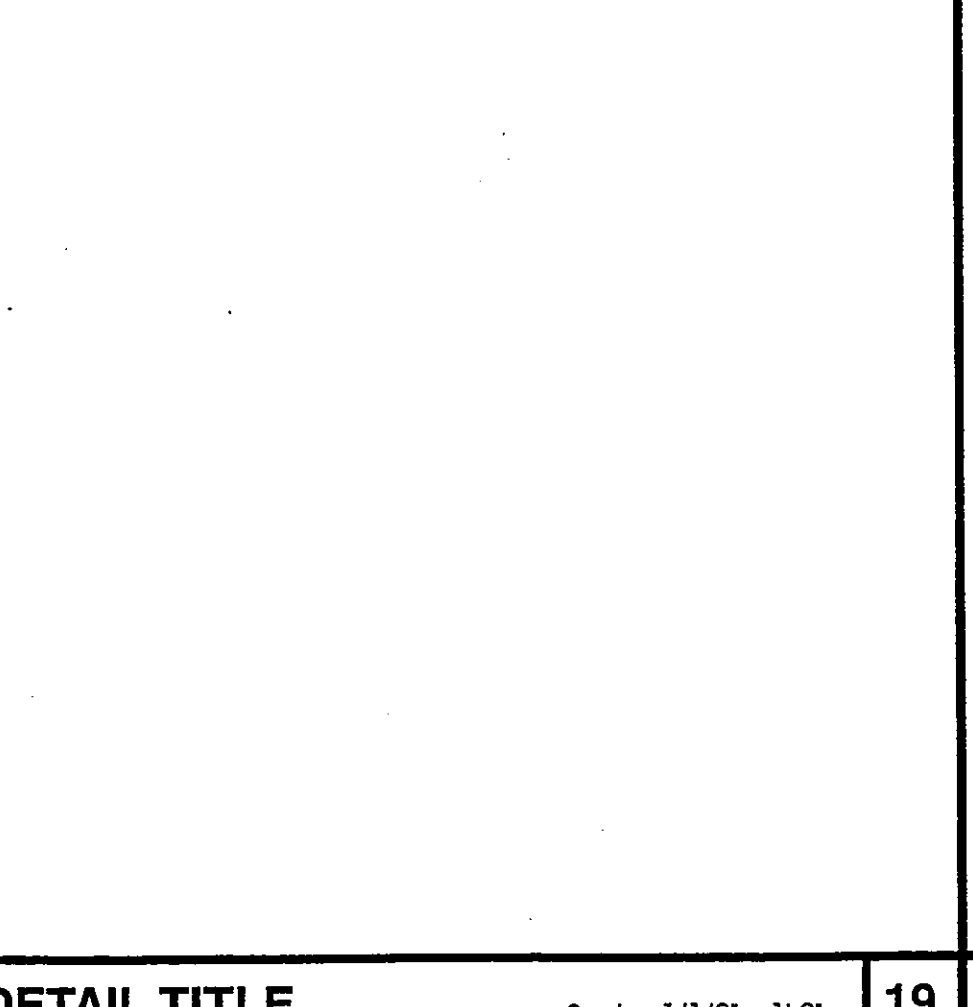

**DETAIL TITLE** Scale: 1/12" = 1'-0" 19

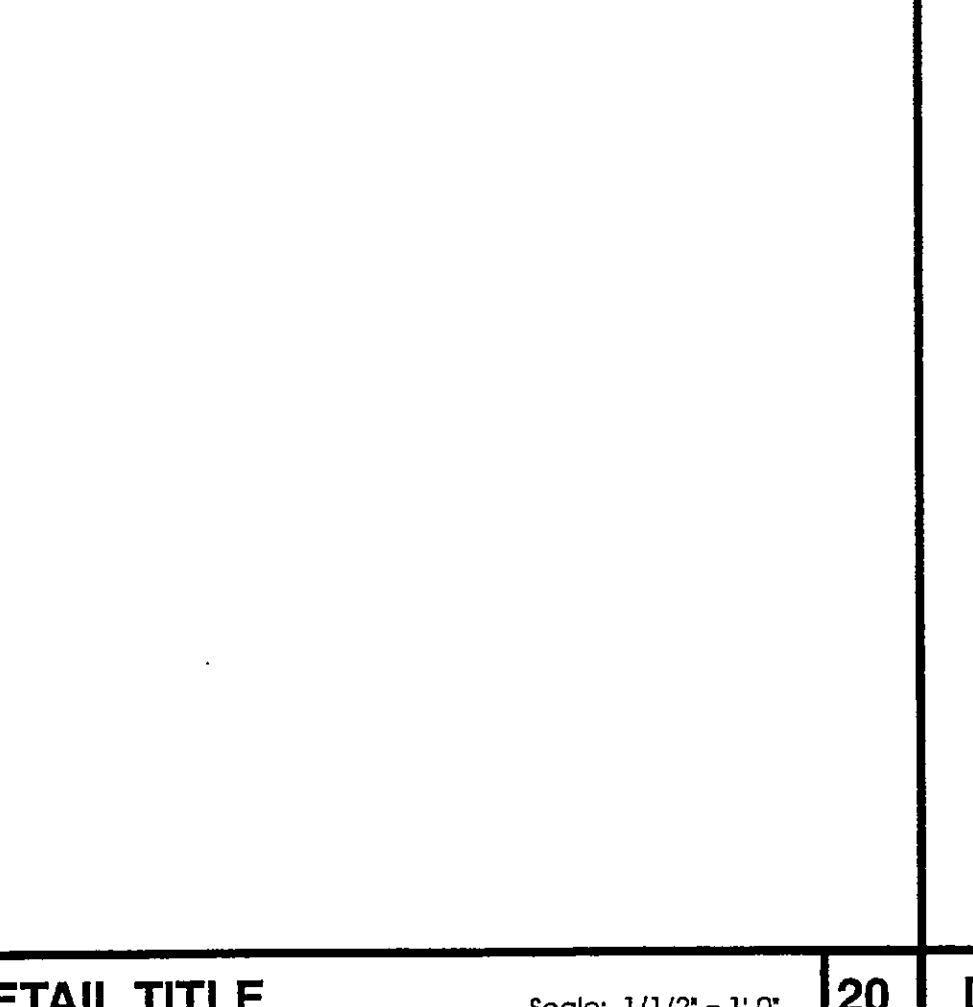

**DETAIL TITLE** Scale: 1/12" = 1'-0" 20

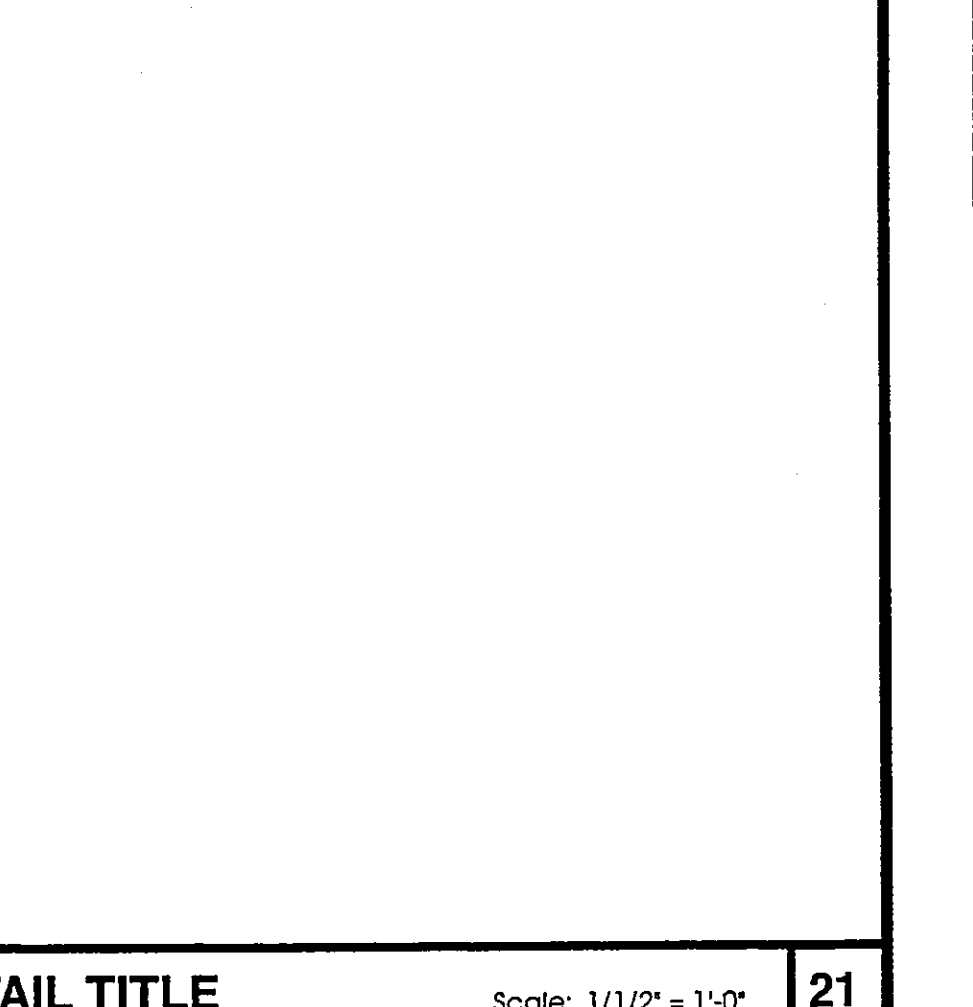

**DETAIL TITLE** Scale: 1/12" = 1'-0" 21

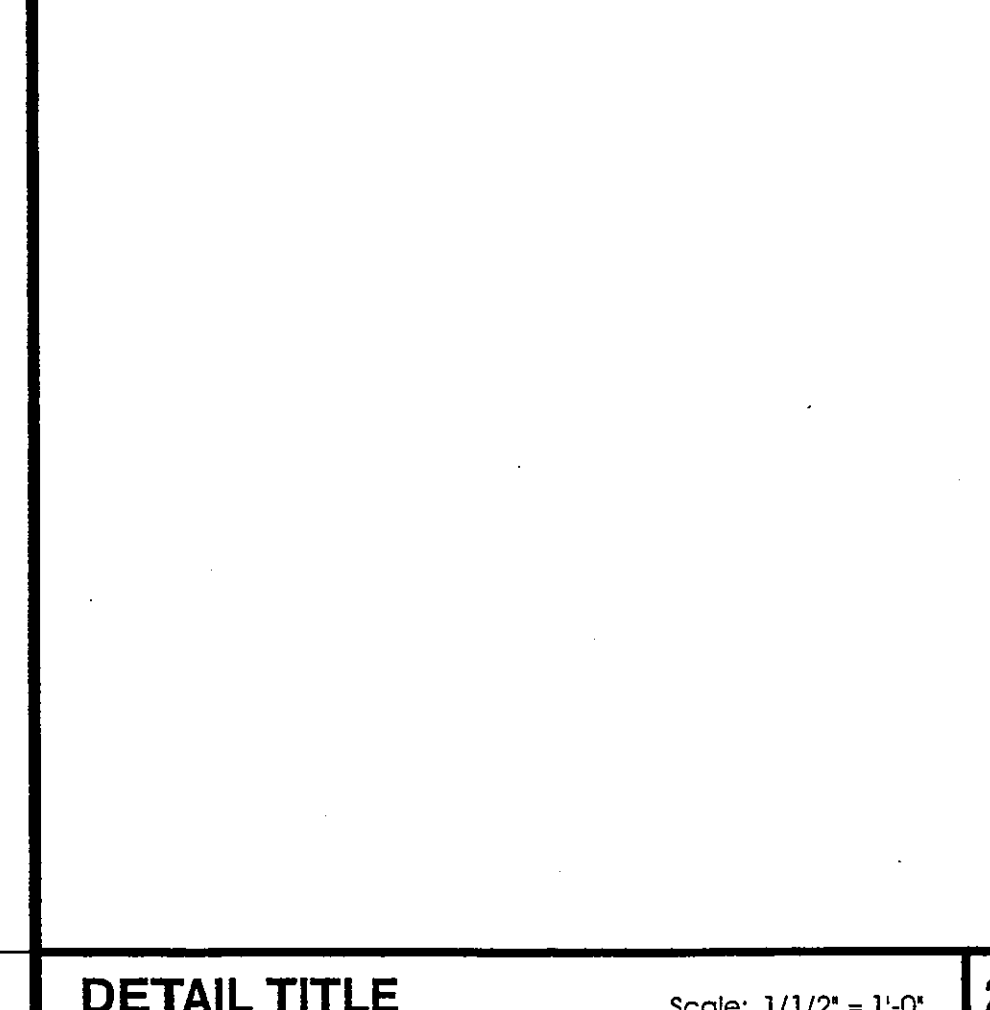

**DETAIL TITLE** Scale: 1/12" = 1'-0" 22

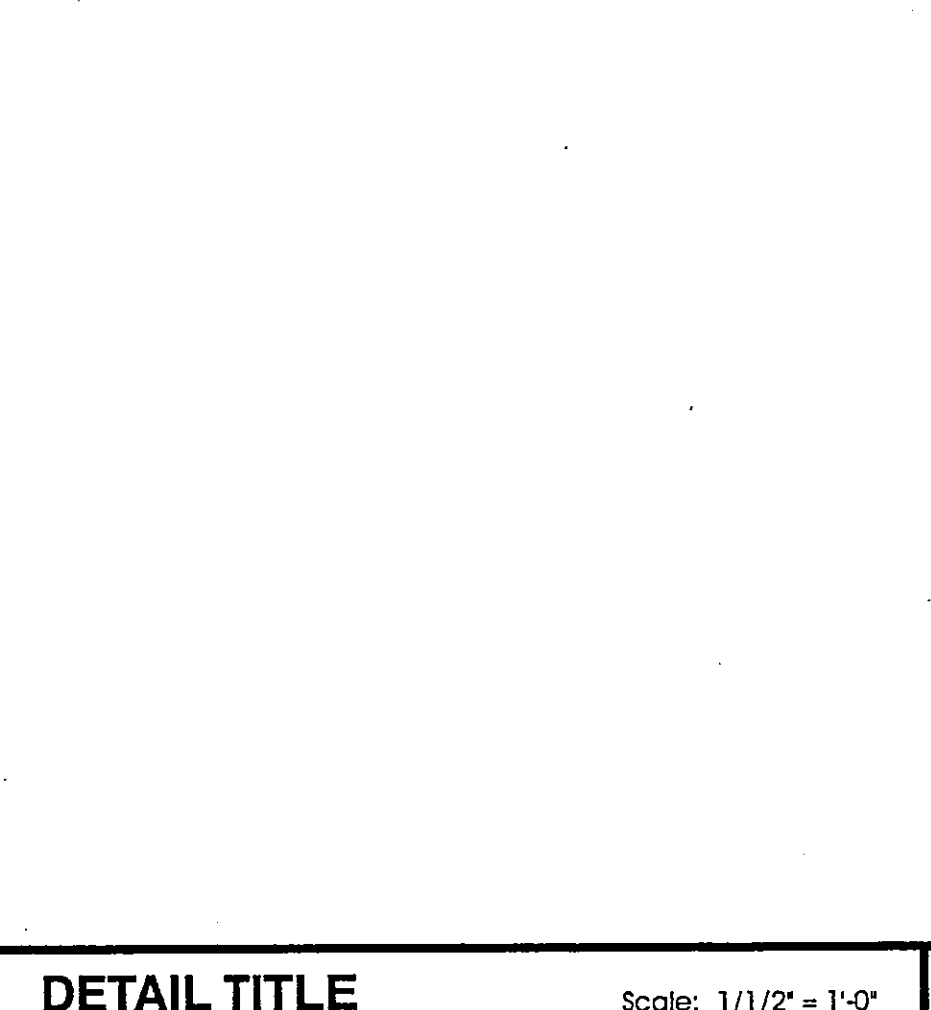

**DETAIL TITLE** Scale: 1/12" = 1'-0" 23

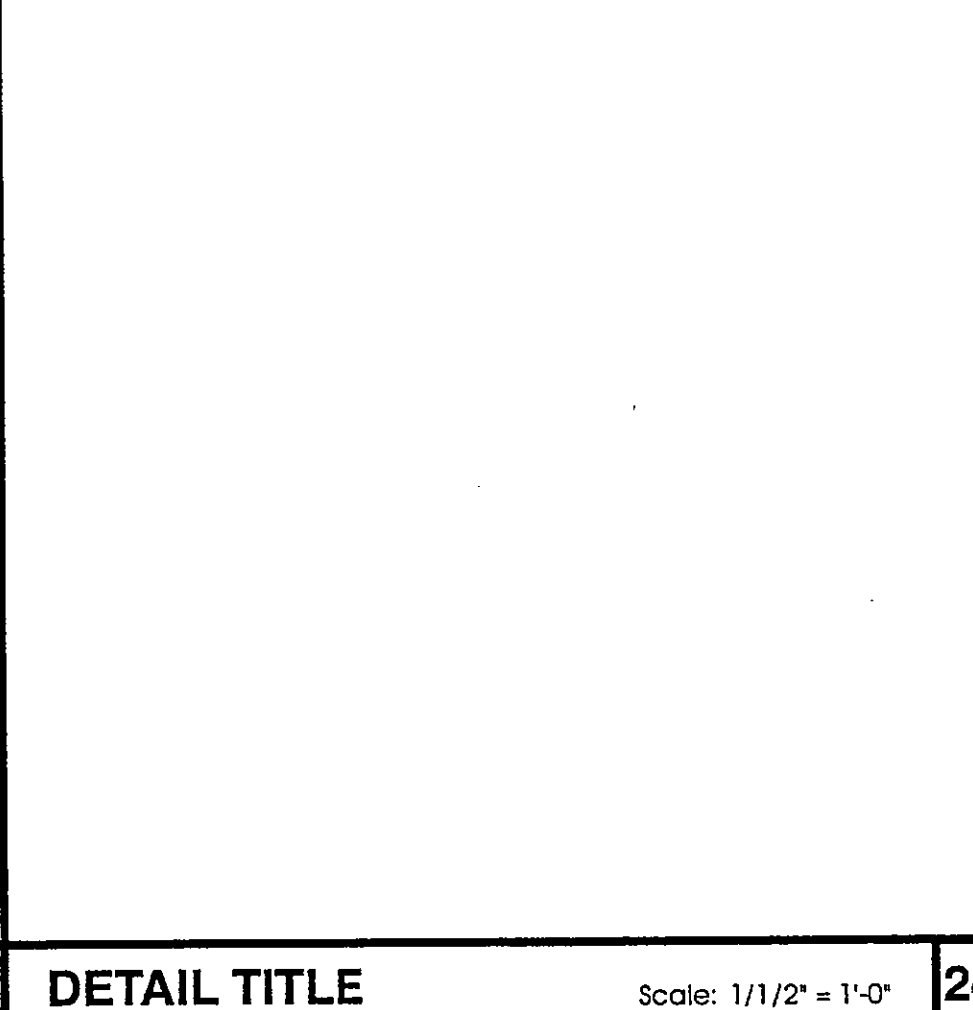

**DETAIL TITLE** Scale: 1/12" = 1'-0" 24

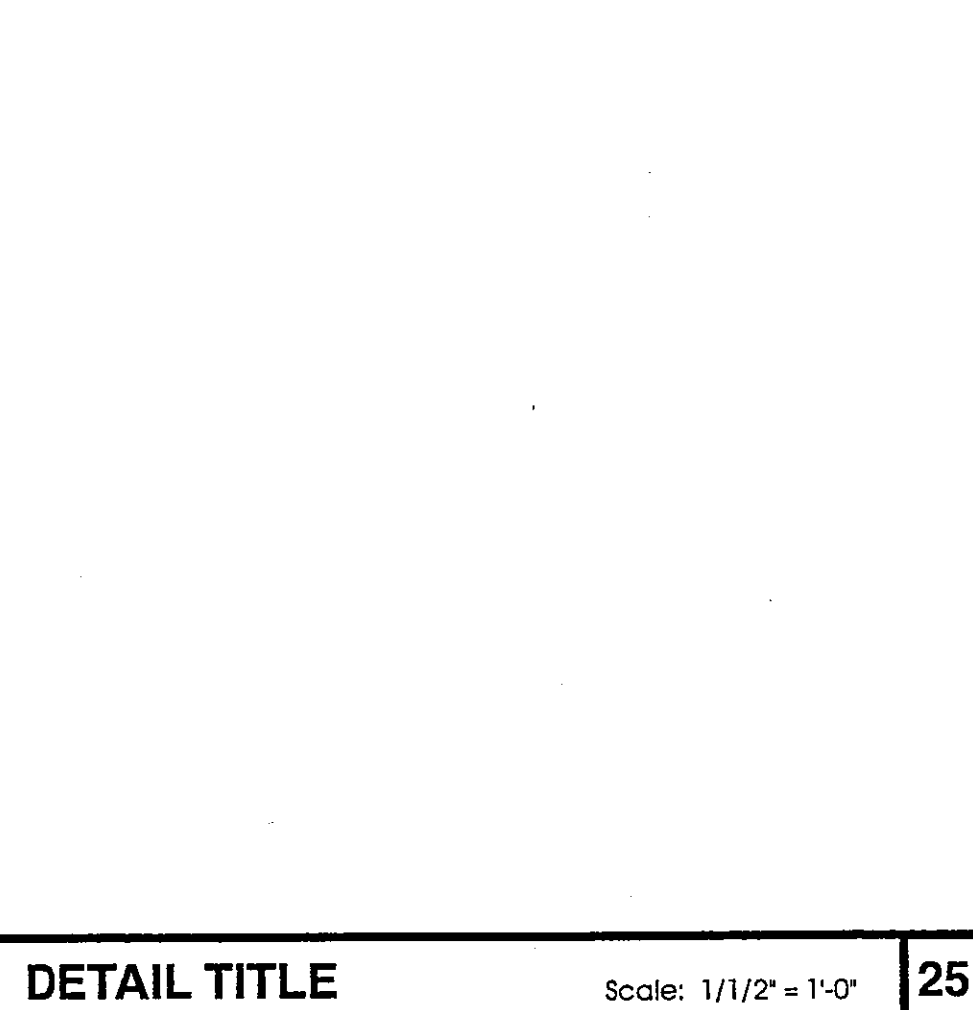

**DETAIL TITLE** Scale: 1/12" = 1'-0" 25

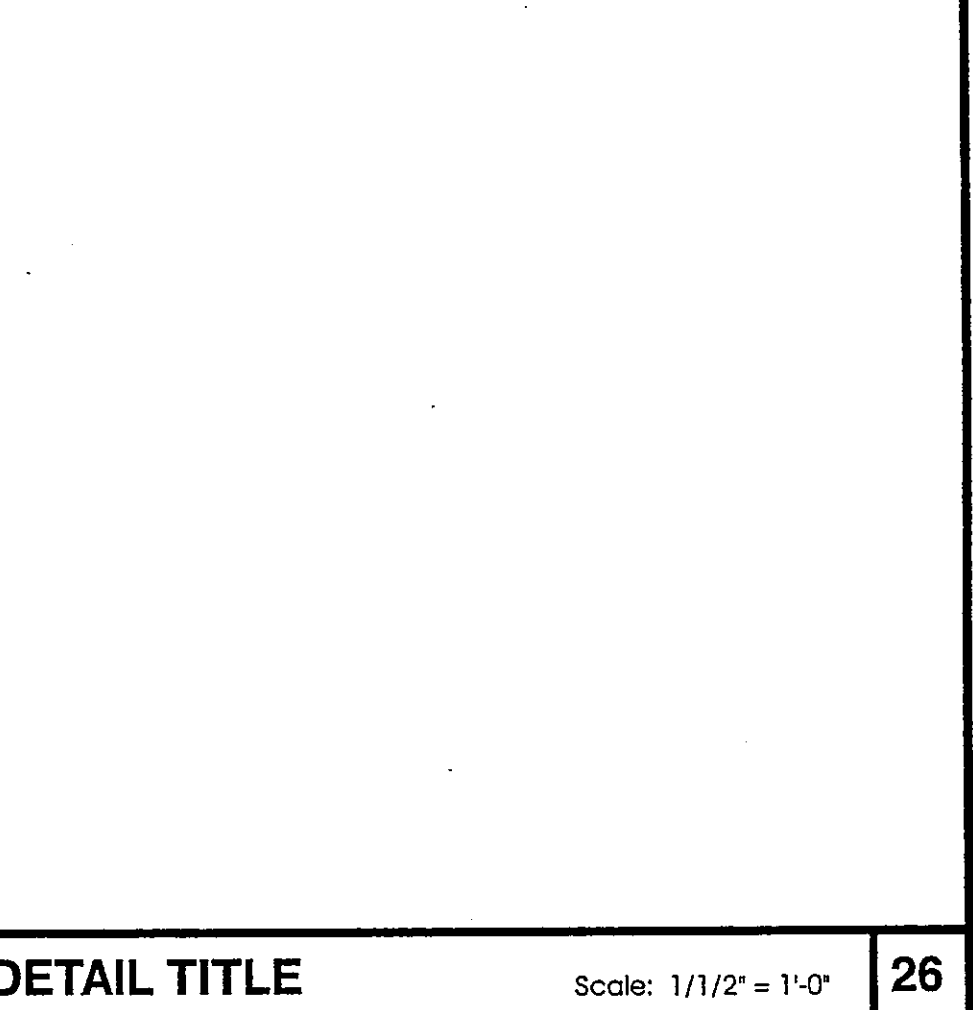

**DETAIL TITLE** Scale: 1/12" = 1'-0" 26

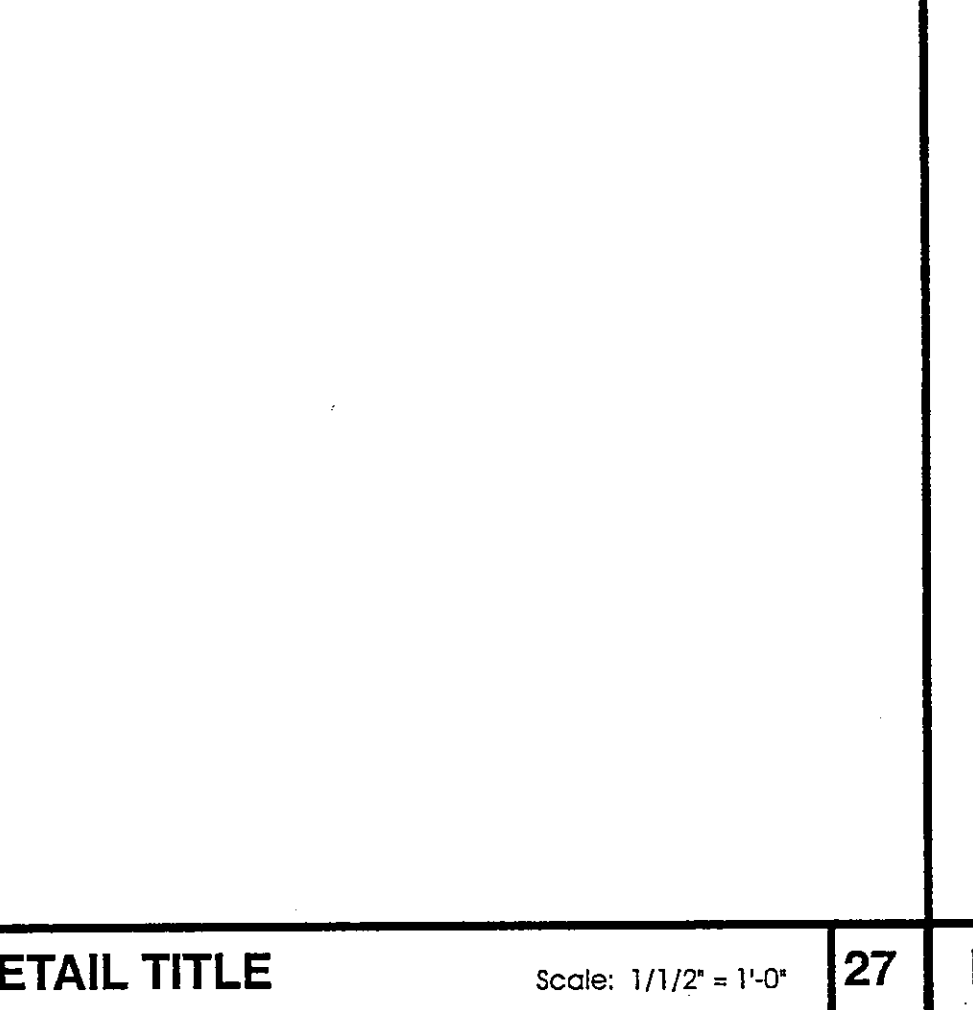

**DETAIL TITLE** Scale: 1/12" = 1'-0" 27

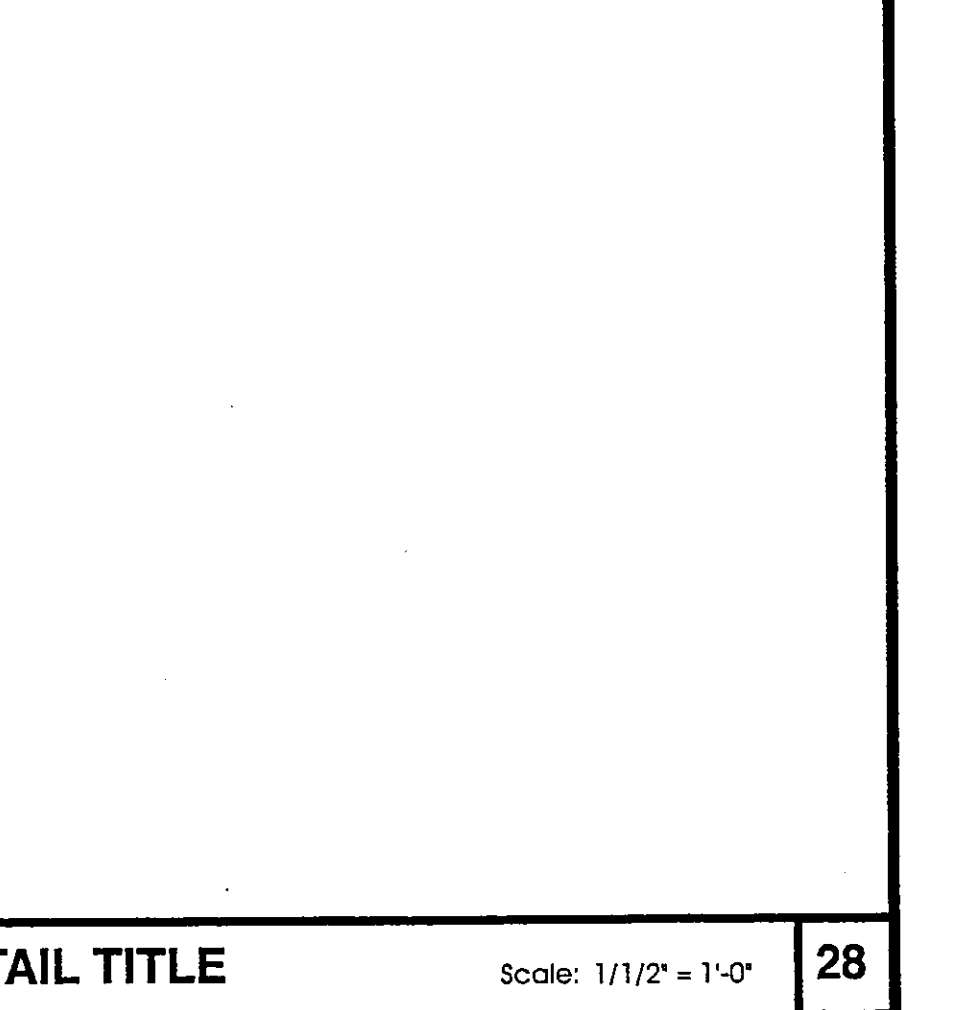

**DETAIL TITLE** Scale: 1/12" = 1'-0" 28

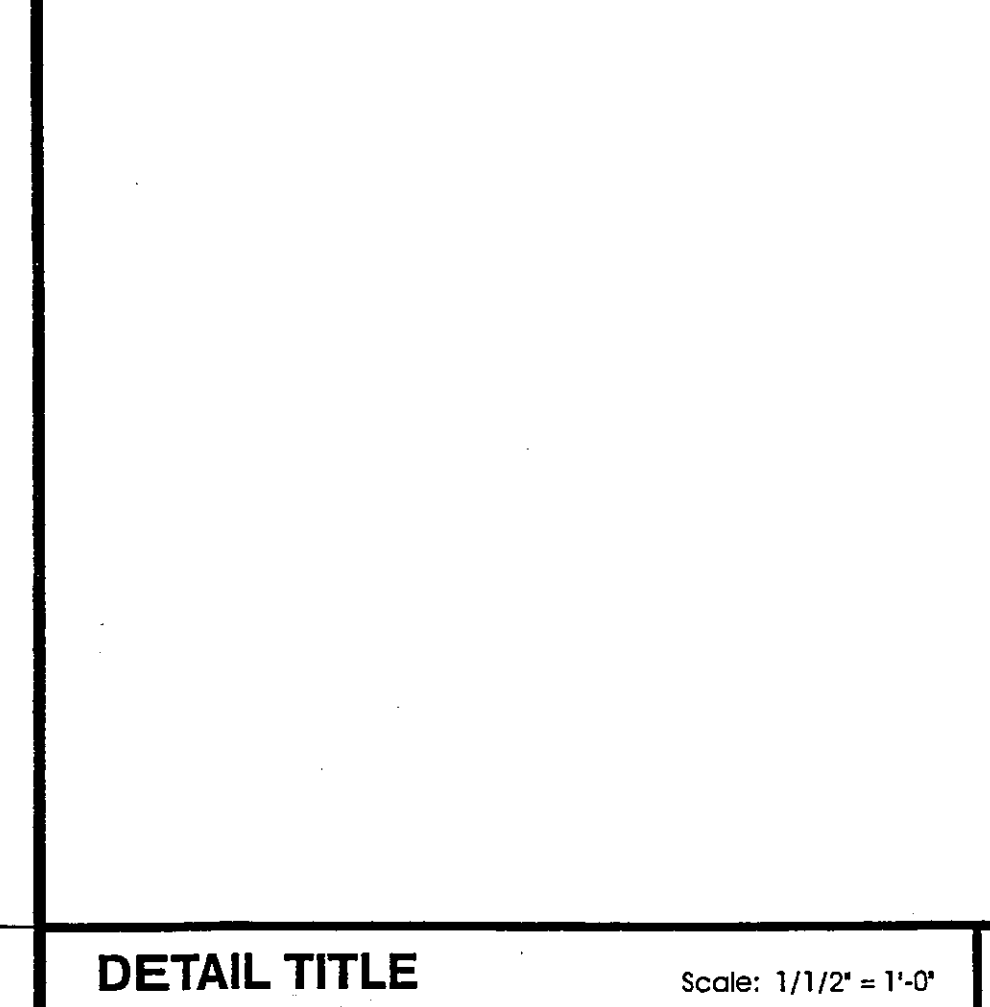

**DETAIL TITLE** Scale: 1/12" = 1'-0" 29

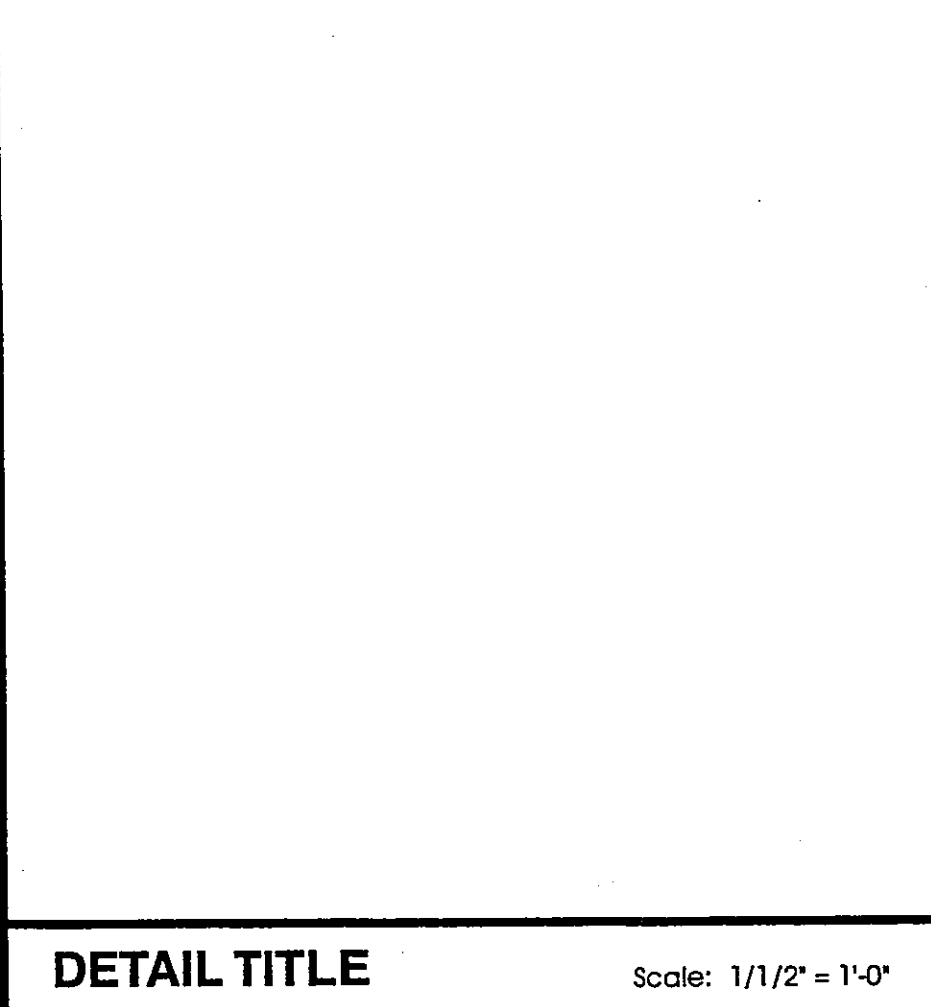

**DETAIL TITLE** Scale: 1/12" = 1'-0" 30

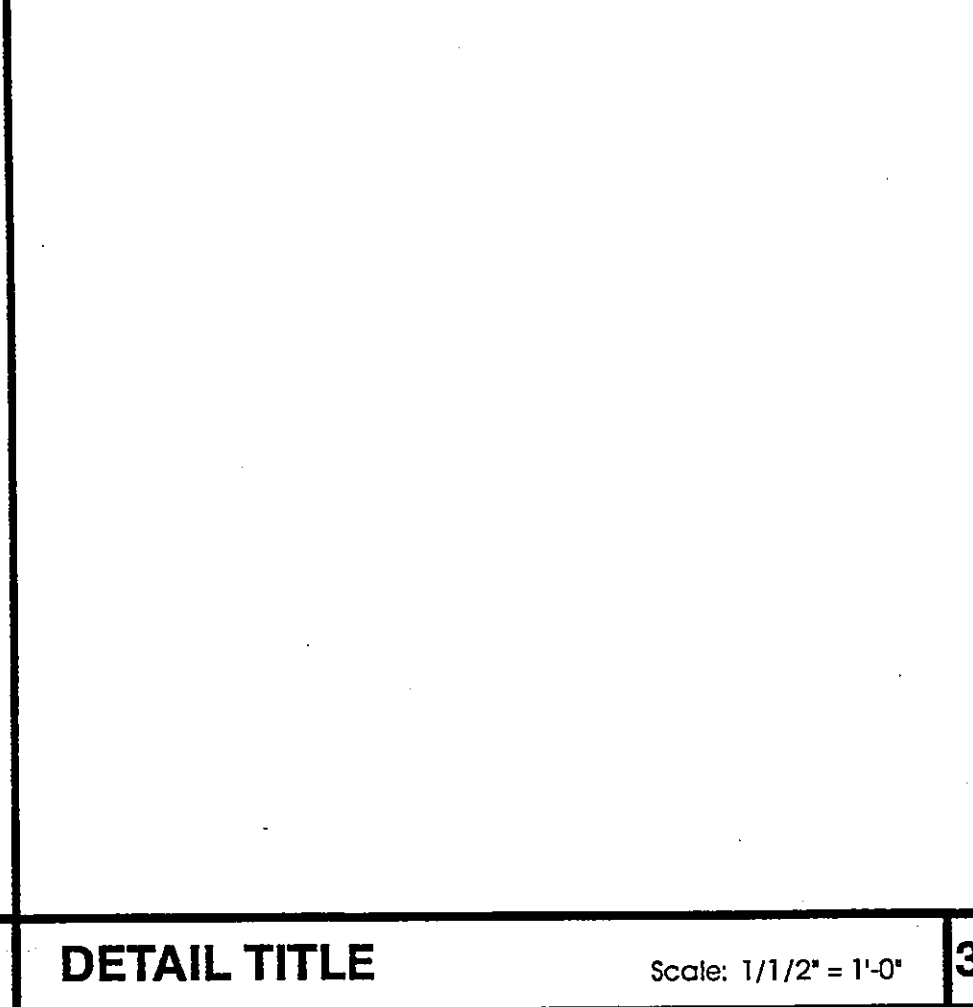

**DETAIL TITLE** Scale: 1/12" = 1'-0" 31

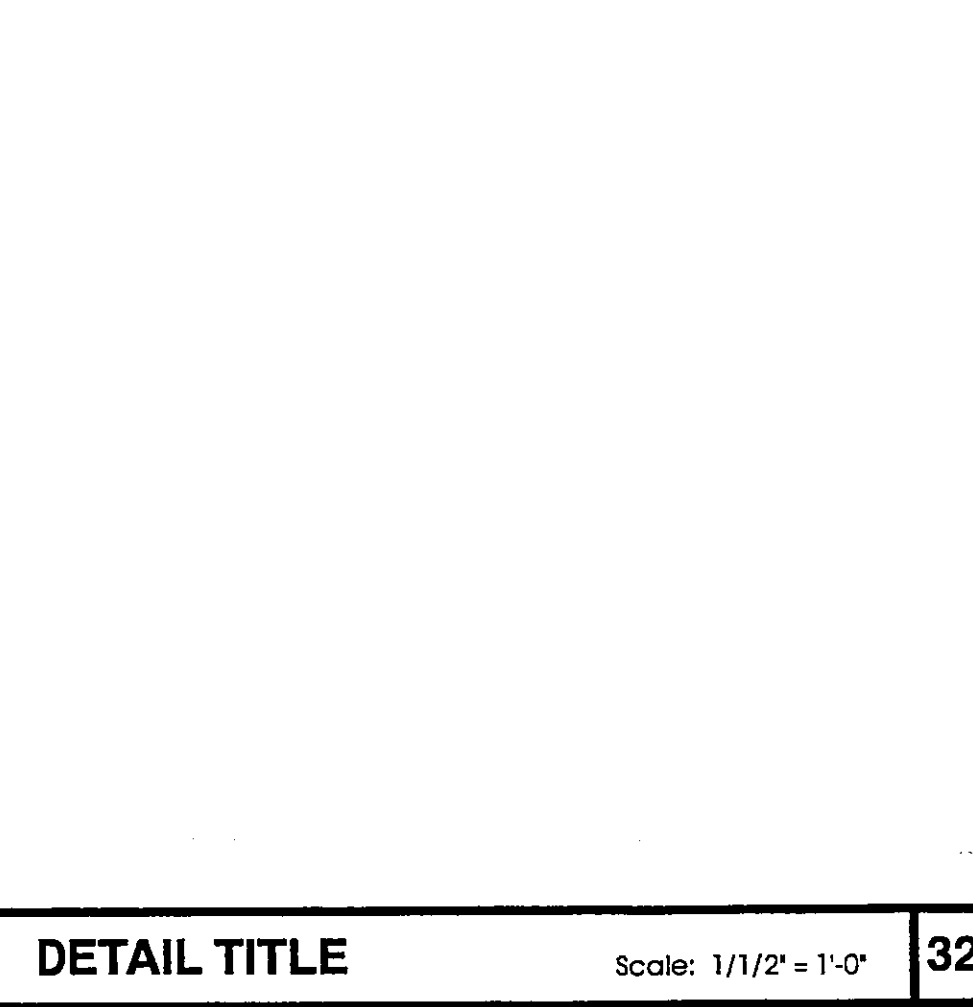

**DETAIL TITLE** Scale: 1/12" = 1'-0" 32

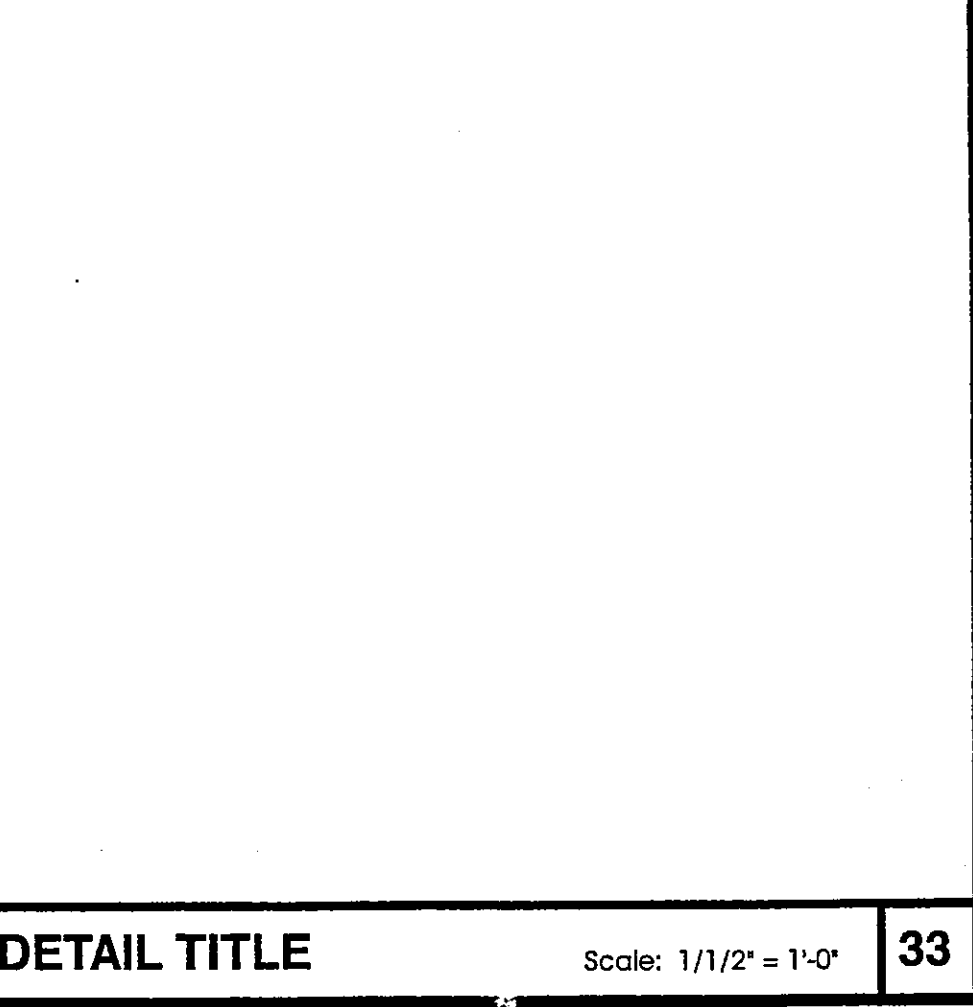

**DETAIL TITLE** Scale: 1/12" = 1'-0" 33

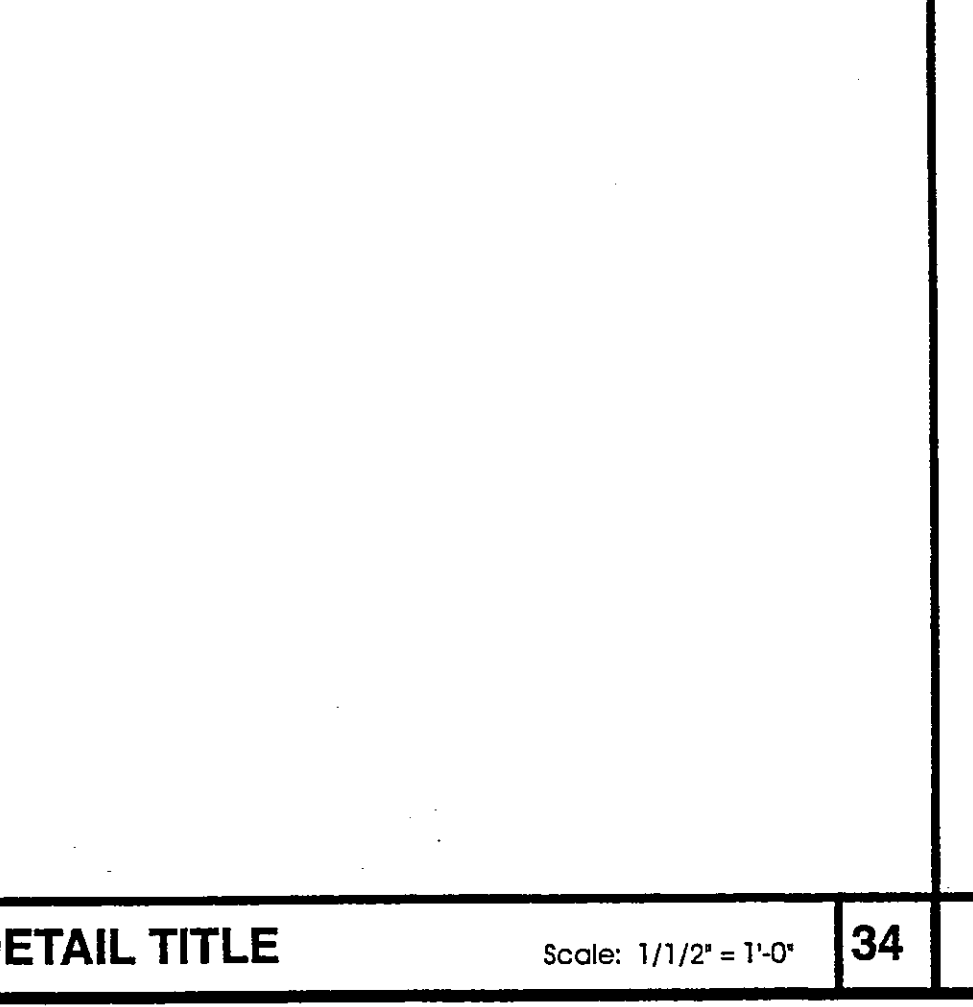

**DETAIL TITLE** Scale: 1/12" = 1'-0" 34

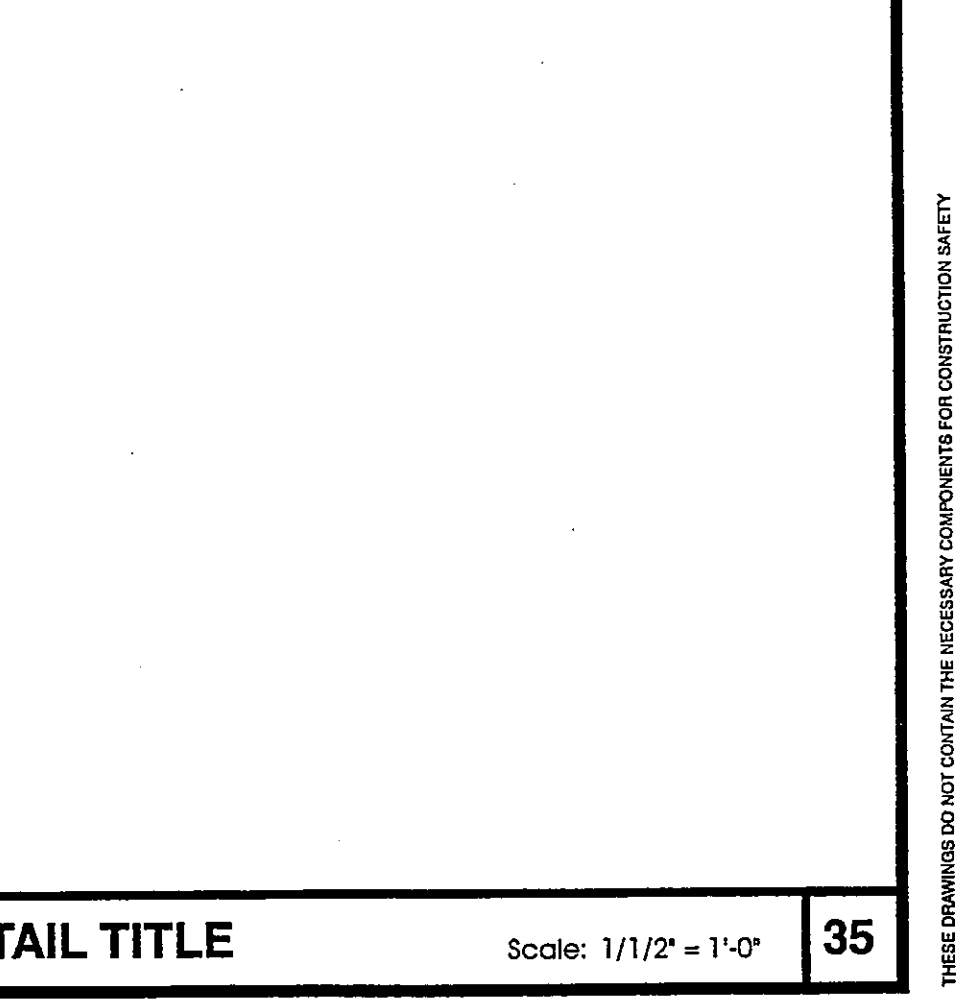

**DETAIL TITLE** Scale: 1/12" = 1'-0" 35

**RON YEO, FAIA ARCHITECT, INC.**  
 500 JASMINE AVENUE, CORONA DEL MAR  
 CALIFORNIA 92625 P-949-644-8111 F-949-644-0449  
 PATRICK MARR, AIA, PE, ASSOCIATE ARCHITECT



12/23/03 update revisions

**POINT VICENTE INTERPRETIVE CENTER EXPANSION**  
 31501 Palos Verdes Drive West  
 Rancho Palos Verdes, CA

**Architectural Details**

DRAWN  
 PM/MG  
 CHECKED  
 RY  
 DATE  
 2/1/99  
 SCALE  
 (as noted)  
 JOB. NO.  
 95-120  
 SHEET  
**D-3**  
 29 OF 69 SHEETS

12/23/03

Ron Yeo, Architect  
 500 Jasmine Avenue  
 Corona Del Mar, CA 92625  
 P-949-644-8111  
 F-949-644-0449  
 12/23/03