

RYAN PARK 4 of 7
 HANDICAP RAMP

M					
L					
K					
J					
I					
H					
G					
F					
E					
D					
C					
B					
A					

- NOTES:
- HANDRAIL COMPLIANT WITH TITLE 24, STATE OF CALIFORNIA, SHALL BE PLACED ALONG BOTH SIDE OF THE RAMP AND ON THE SOUTH AND EAST SIDES OF THE TOP LANDING
 - DISTANCE BETWEEN LANDINGS IS 30'
 - LANDINGS SLOPED 1.5% EACH DIRECTION

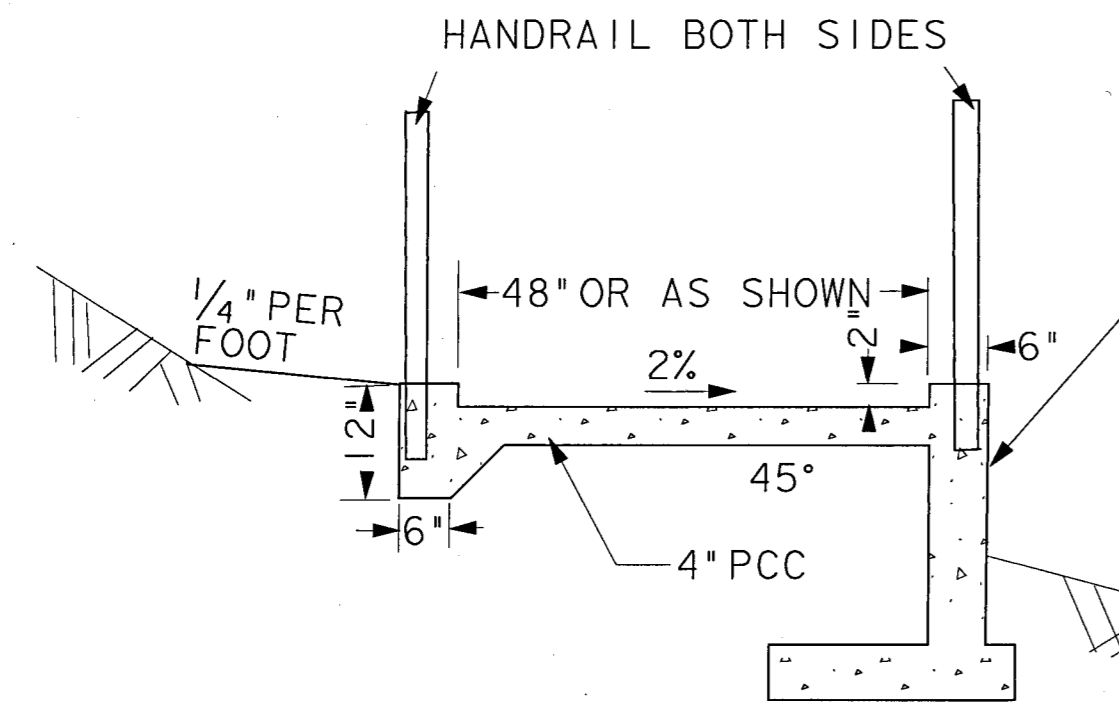

KEY SYMBOLS

	EXISTING
	NEW ITEM
	RELOCATED ITEM
	REMOVE

- KEYNOTE LEGEND
- CONC CURB
 - CONC SIDEWALK
 - CONC WALL
 - CONC STEPS
 - SAND
 - TURF
 - RUBBERIZED SURFACE PER DETAIL 1, C-3
 - "FOREST FIBER PLAY" BY FOREST WOOD FIBER PRODUCTS, TEL (909) 678-7574 FAX (909) 678-2684
 - RELOCATE BENCH, SECURE PER EXISTING
 - HANDICAP RAMP PER SECTION A-A, SHT. C-4 NIC
 - ADA COMPLIANT DRINKING FOUNTAIN, HAWES MODEL 3502 (3-BUBBLER) STAINLESS STEEL PEDESTAL DRINKING FOUNTAIN IN GREEN POWDER COAT FINISH, TEL (909) 594-7088 CONST 3' X 3' X 6" BASE SEE SPECS
 - RELOCATE WATER BOX TO DRINKING FOUNTAIN
 - 4" PCC WALK
 - CUT SOD AT EXISTING AND NEW CURB PER DETAIL 3, SHT. C-7
 - REMOVE SAND AND RESOD
 - CMU WALL PER APWA TYPE 5, 614-1, H=AS SHOWN

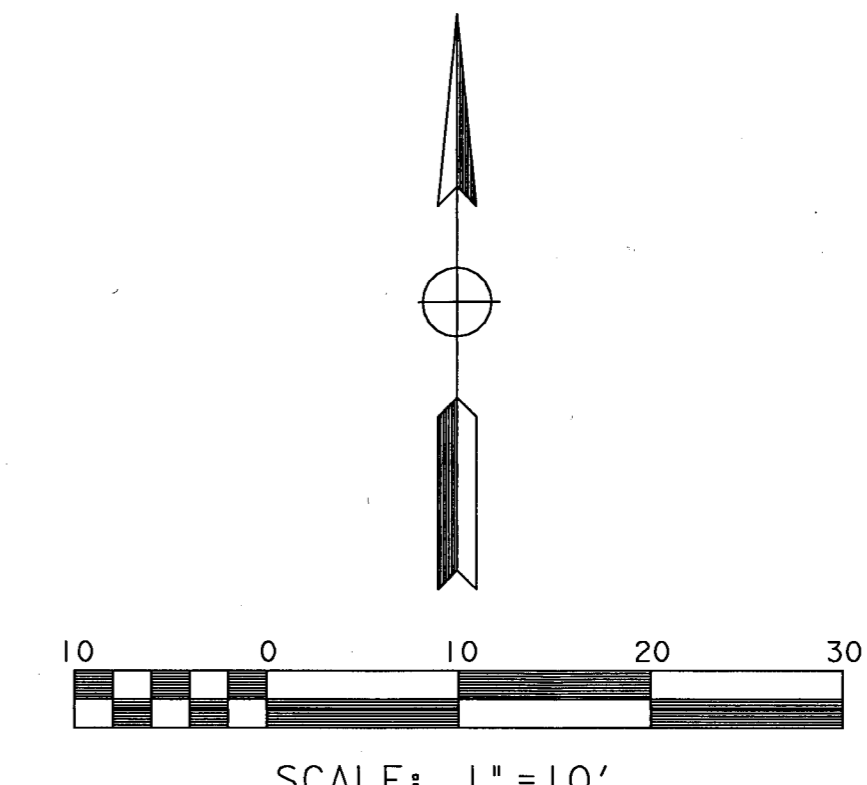
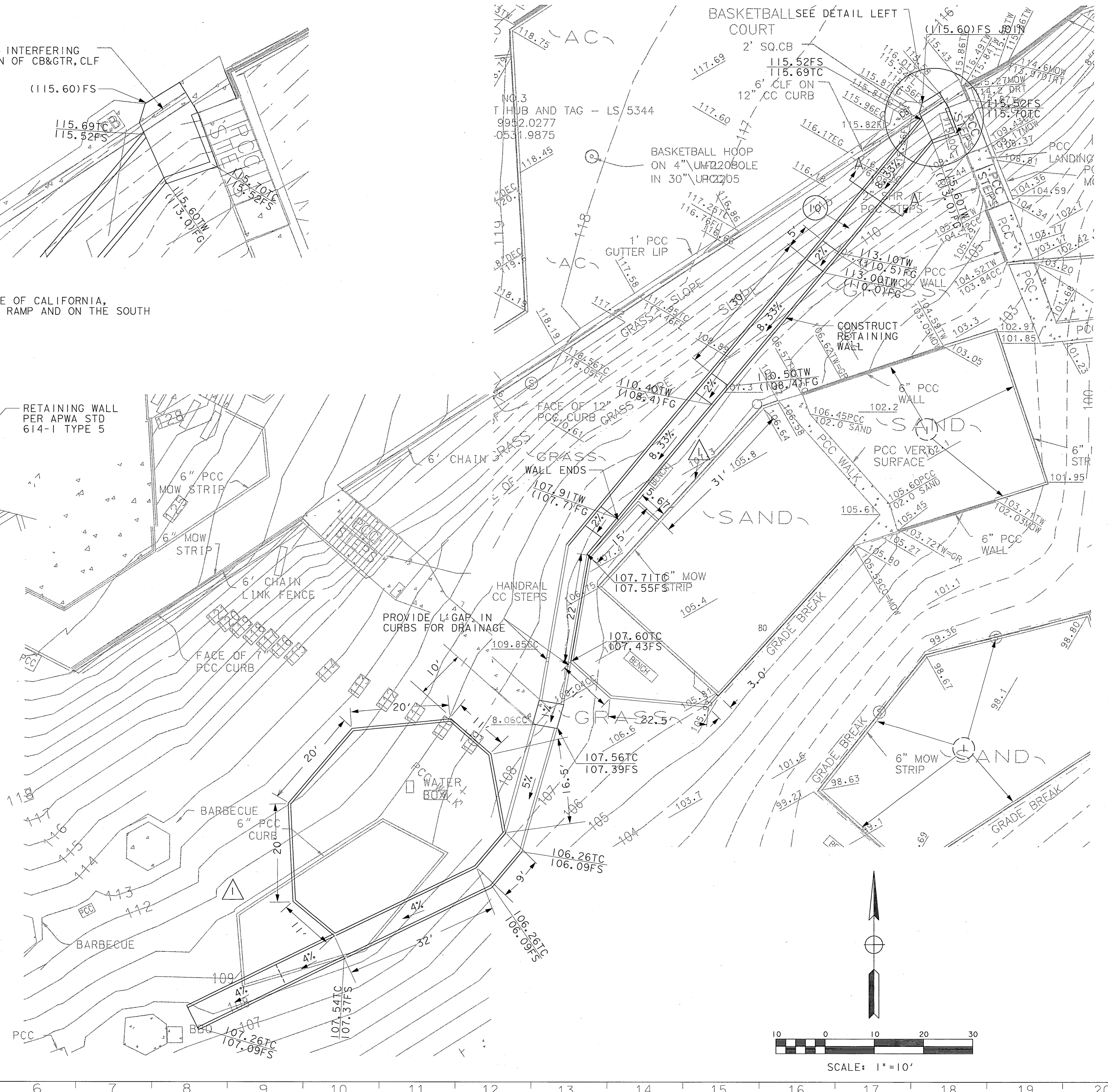
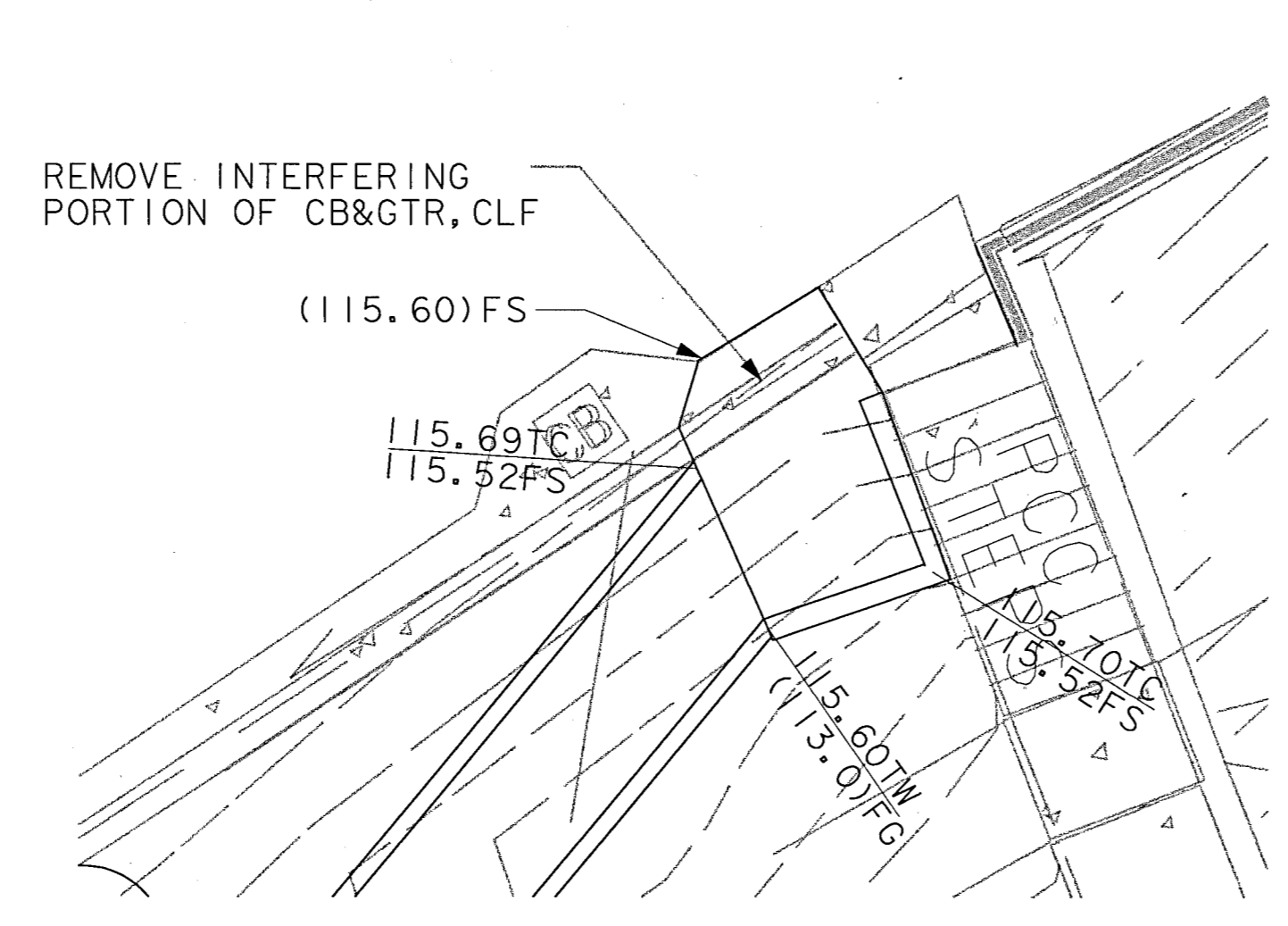

PLANS PREPARED BY

JOHN M. CRUIKSHANK
 DATE 9/30/05
 C50792
 RCE NO. EXP. DATE

JOHN M. CRUIKSHANK CONSULTANTS, INC (310) 320-8882
 2341 W. 205TH STREET, STE 103, TORRANCE, CA 90501

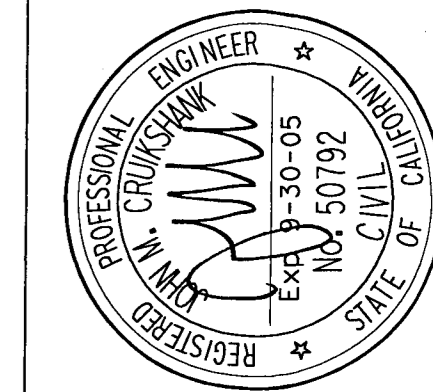

RYAN PARK IMPROVEMENTS

HANDICAP RAMP

ROBERT E. RYAN COMMUNITY PARK
 RANCHO PALOS VERDES, CA 90275

BLDG. NO. _____

PROJECT NO. 32714

SCALE AS SHOWN

DATE 10/28/02

JOB CAPTAIN JCS

DRAWN BY JCS

CHECKED BY JMC

SHEET NO. 4

C-4

OF 7 SHEETS

SHEET 4 OF 7 SHEETS INDEX NUMBER

FOR REDUCED PLANS ORIGINAL SCALE IS IN INCHES