

COMMUNITY CENTER

LADERA LINDA PARK
RANCHO PALOS VERDES
CALIFORNIA

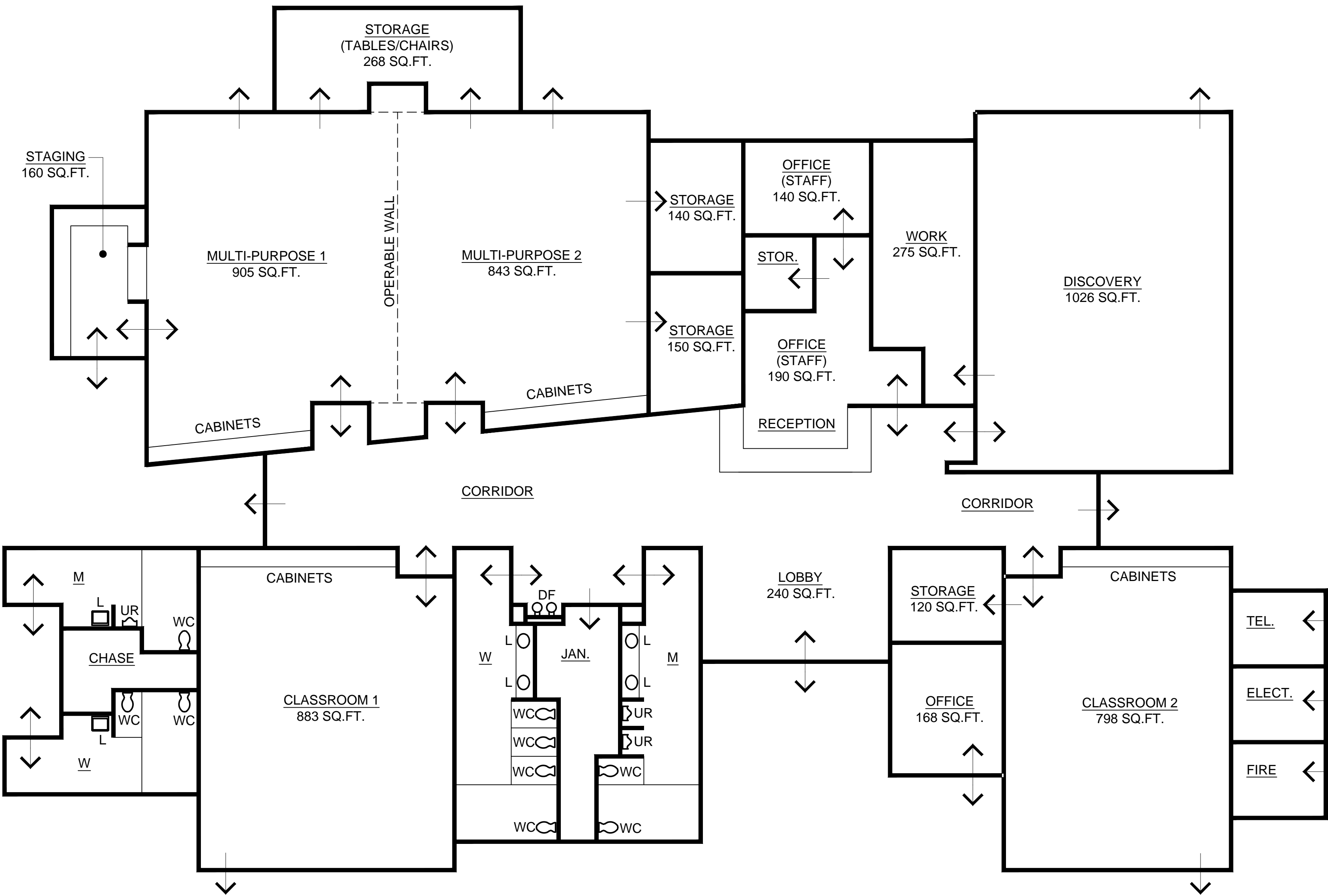

FLOOR PLAN STUDY

APPROXIMATE NORTH

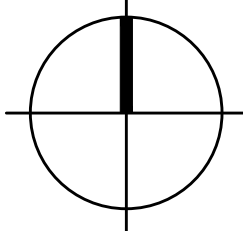

SCALE: 1/8" = 1'-0"
FEBRUARY 14, 2017

FLOOR PLAN

9,137 SQ. FT.

THE BUILDING AREAS INDICATED ON THIS PLAN ARE MEASURED TO THE CENTERLINE OF THE SURROUNDING WALL LINE. THE AREAS INDICATED ARE FOR SCHEMATIC DESIGN PURPOSES ONLY. THE ACTUAL BUILDING AREA WILL INCREASE BY 1/2 TIMES THE EXTERIOR WALL THICKNESS TIMES THE BUILDING PERIMETER. THE ACTUAL ROOM AREAS WILL DECREASE BY 1/2 TIMES THE WALL THICKNESS TIMES THE ROOM PERIMETER.

© meyer and associates



meyer and associates
architecture
landscape architecture
park and recreation planning

23265 south pointe drive, suite 102
laguna hills, ca 92653
phone (949) 380-1151
fax (949) 380-8117

MEYER JOB NO. 470

LADERA LINDA
COMMUNITY
CENTER

FLOOR PLAN
STUDY