

CITY OF RANCHO PALOS VERDES COMMUNITY DEVELOPMENT DEPARTMENT RESTROOM ADA COMPLIANCE

CITY OF RANCHO PALOS VERDES
BUILDING & SAFETY DIVISION
APPROVAL

This set of plans & specifications must be kept on the job at all times and it is unlawful to make any changes or alterations on same without written permission from Building & Safety, City of Rancho Palos Verdes. The stamping of these plans and specifications SHALL NOT be held to permit or be approval of the Violation of any provisions on any City Ordinance or State Law
Date: 3/11/10
By: [Signature]



VICINITY MAP

SHEET LIST

- A1 COVER SHEET & SITE PLAN
- A2 PROPOSED FLOOR PLAN & DEMO PLAN
- A3 INTERIOR ELEVATIONS
- A4 DETAILS

PROJECT DESCRIPTION

SCOPE OF WORK TO INCLUDE REMODEL OF EXISTING WOMEN'S REST ROOM AND CHANGE OF MEN'S REST ROOM TO MEN'S AND UNISEX REST ROOMS. TOTAL OF 190 S.F. TO BE REMODELED. CHANGES TO INCLUDE: NEW DOORS, TILE, FIXTURES, PAINT AND ELECTRICAL SWITCHES AND LIGHTS

BUILDING DATA

LEGAL DESCRIPTION: APN-7473-002-913
BUILDING AREA: 4438 S.F. (UNCHANGED)
APPLICABLE CODES:
THE BUILDING SHALL CONFORM IN ITS ENTIRETY TO: 2007 CALIFORNIA BUILDING CODE (CBC), CALIFORNIA MECHANICAL CODE (CMC), CALIFORNIA PLUMBING CODE (CPC), CALIFORNIA ELECTRICAL CODE (CEC) & CITY ORDINANCE, AND THE 2008 CALIFORNIA ENERGY STANDARDS

GENERAL NOTES

1. ALL CONSTRUCTION WASTE AND DEBRIS MUST BE CONTAINERIZED AT ALL TIMES.
2. ANY AND ALL DEVIATIONS FROM THE PLANNING DEPARTMENT OR COMMISSION APPROVED PLANS REQUIRE THAT REVISED PLANS BE SUBMITTED TO THE PLANNING DEPARTMENT/COMMISSION FOR REVIEW AND APPROVAL.
3. ALL GENERAL CONTRACTORS, SUB-CONTRACTORS, ARCHITECTS, & ENGINEERS CONDUCTING BUSINESS WITH THE CITY OF RANCHO PALOS VERDES ARE REQUIRED TO MAINTAIN A CURRENT CITY BUSINESS LICENSE.

PROJECT DIRECTORY

ARCHITECT/STRUCTURAL ENGINEER:

JMC
John M. Crutcher & Associates, Inc.
411 N. Harbor Blvd, Suite 201
San Pedro, CA 90731
P: 310.241.6550
F: 310.320.8871
www.jmc-2.com

PROJECT OWNER

CITY OF RANCHO PALOS VERDES
RESTROOM REMODEL
30940 HAWTHORNE BLVD.
RANCHO PALOS VERDES, CA 90275

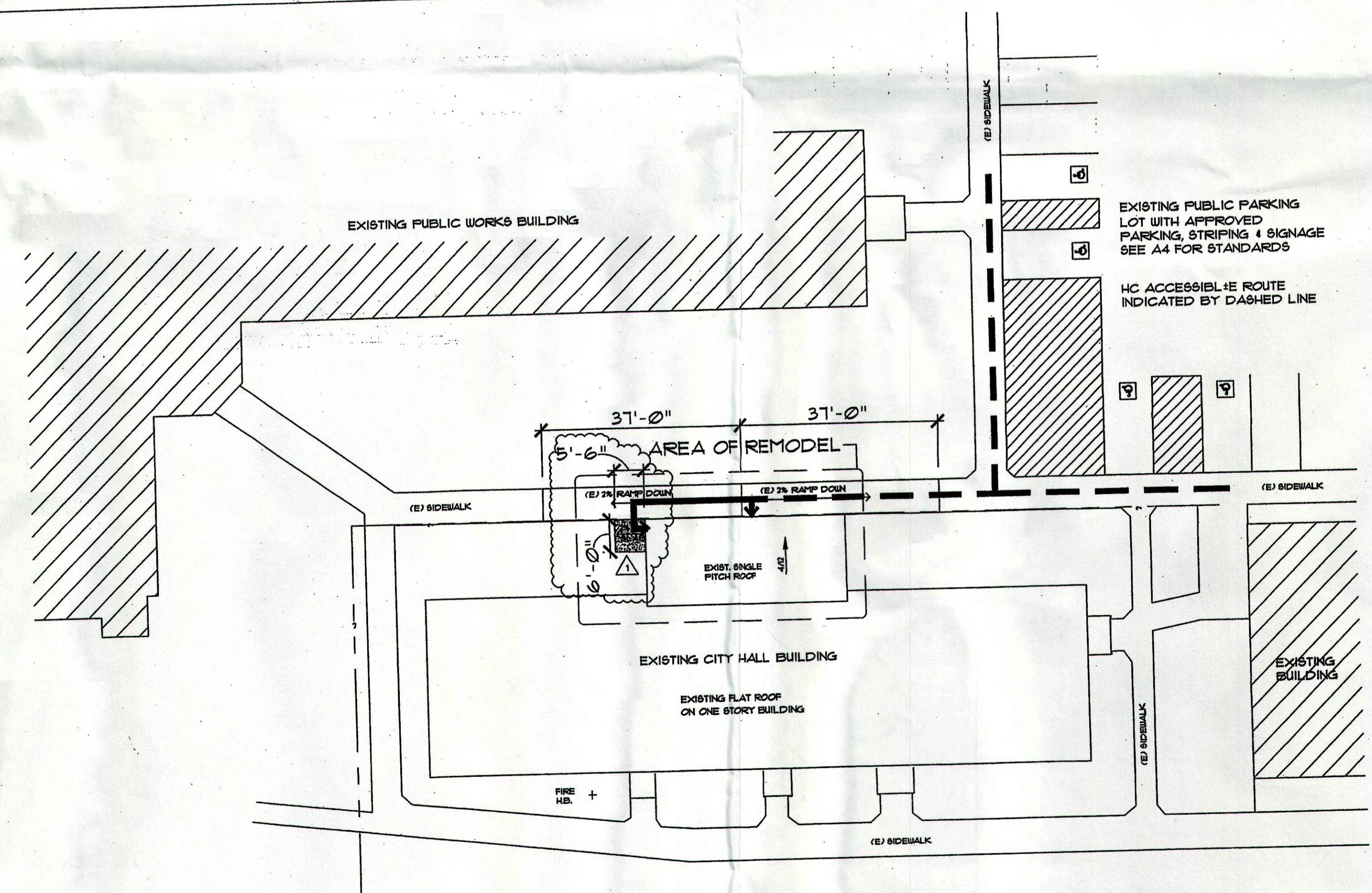

EXISTING ADA ACCESSIBLE ROUTE/SITE PLAN
SCALE: 1"=16'-0"

"All Great Projects Start With JMC"

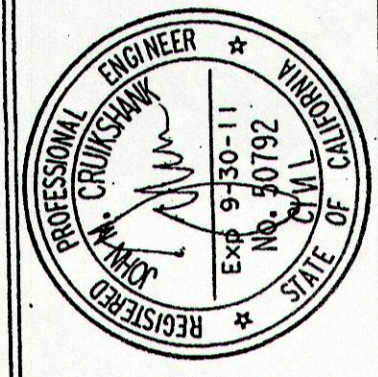

JMC
John M. Crutcher & Associates, Inc.
411 N. Harbor Blvd, Suite 201
San Pedro, CA 90731
P: 310.241.6550
F: 310.320.8871
www.jmc-2.com

PLANS PREPARED BY
CITY OF RANCHO PALOS VERDES
COMMUNITY DEVELOPMENT DEPARTMENT RESTROOM ADA COMPLIANCE
30940 HAWTHORNE BLVD.
RANCHO PALOS VERDES, CA 90275
SHEET TITLE
COVER SHEET & SITE PLAN

PROJECT NO.	20080019.00
SCALE	1/2" = 1'-0"
DATE	9/29/10
DESIGNED BY	DAVID HOPKINS
DRAWN BY	STEVE HOPKINS
CHECKED BY	DAVID HOPKINS
SHEET NO.	A1
	1 OF 4 SHEETS

PROJECT NO. SHEET SIZE: 24x36 LEVEL: 5/14/08 DATE: 7/9/08