

M					
L					
K					
J					
I					
H					
G					
F					
E					
D					
C					
B					
A					

DATE	REVISOR	DATE	REVISOR
10/01	JMC	10/01	JCS
CALCULATED/DESIGNED BY	CHECKED BY	DATE	REVISOR
JMC	JCS		

PROJECT ENGINEER

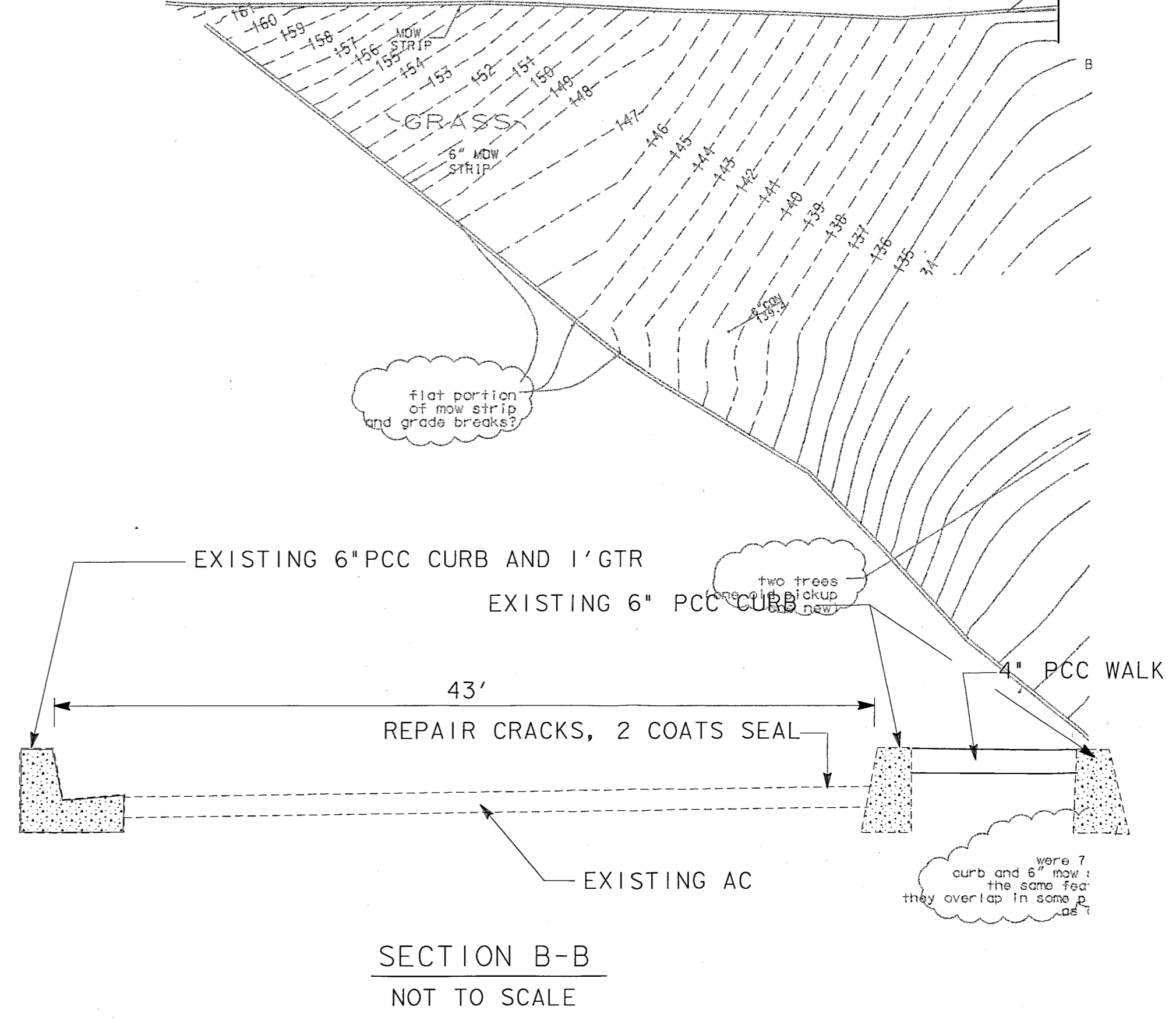
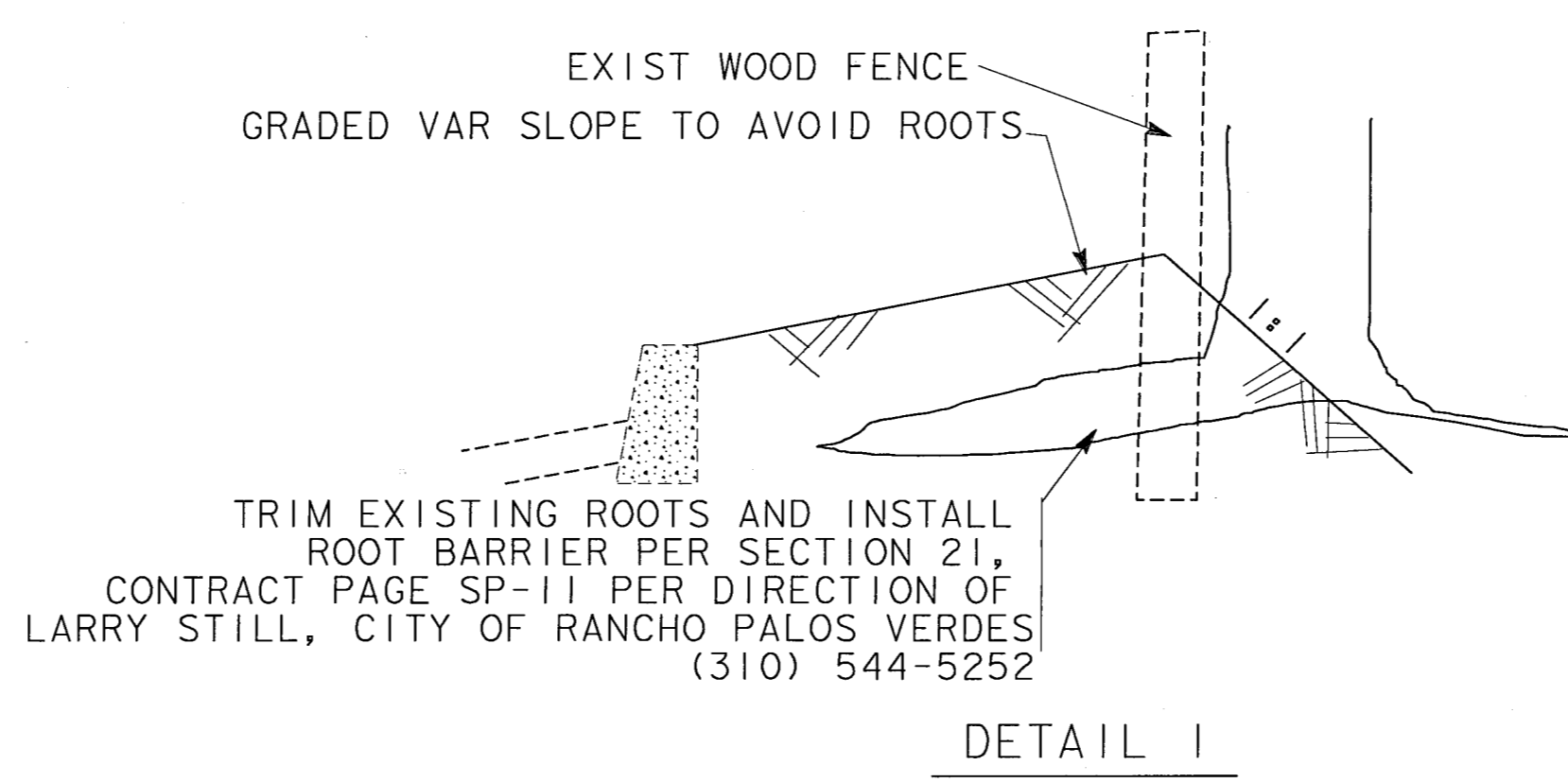
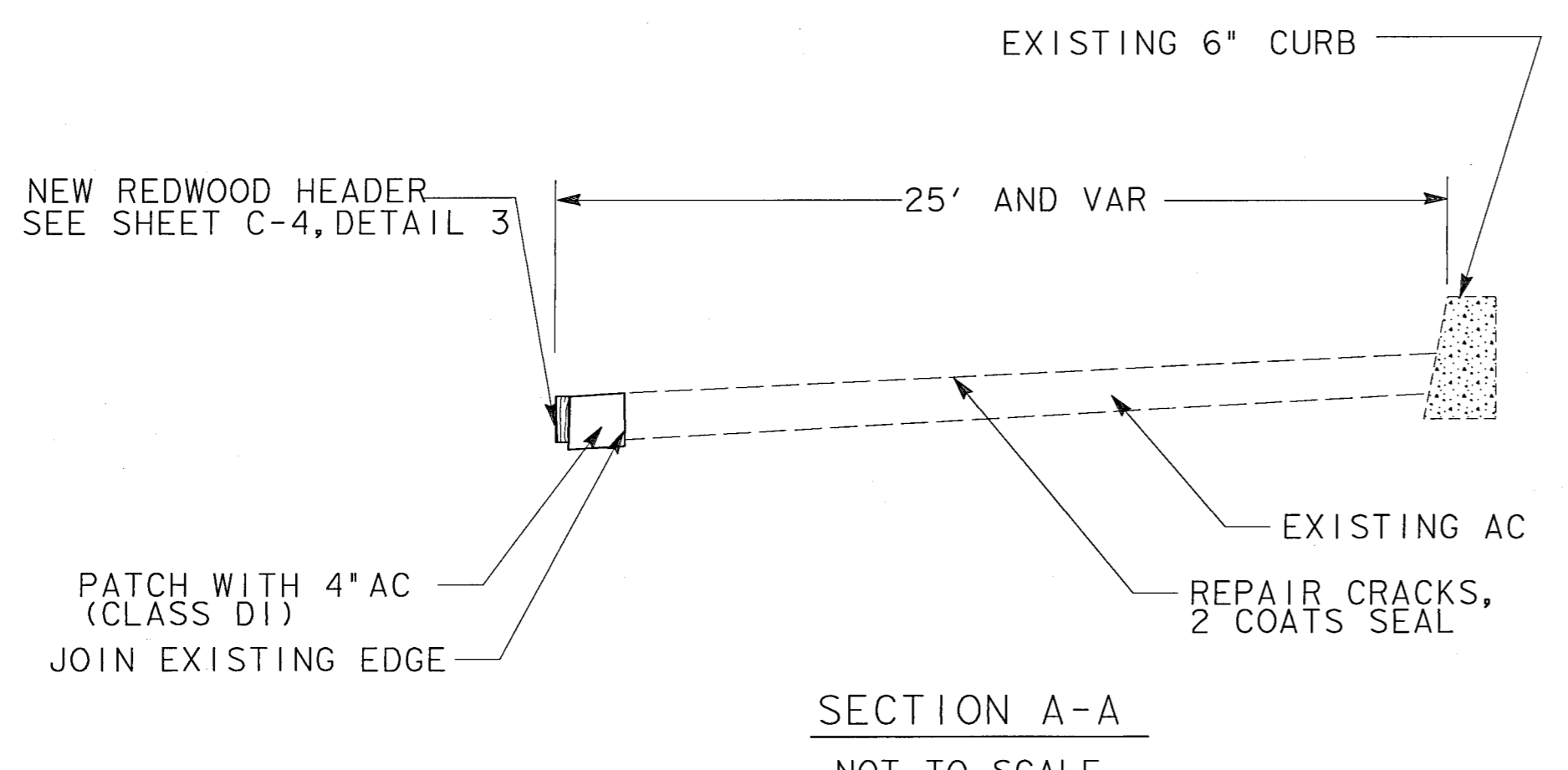
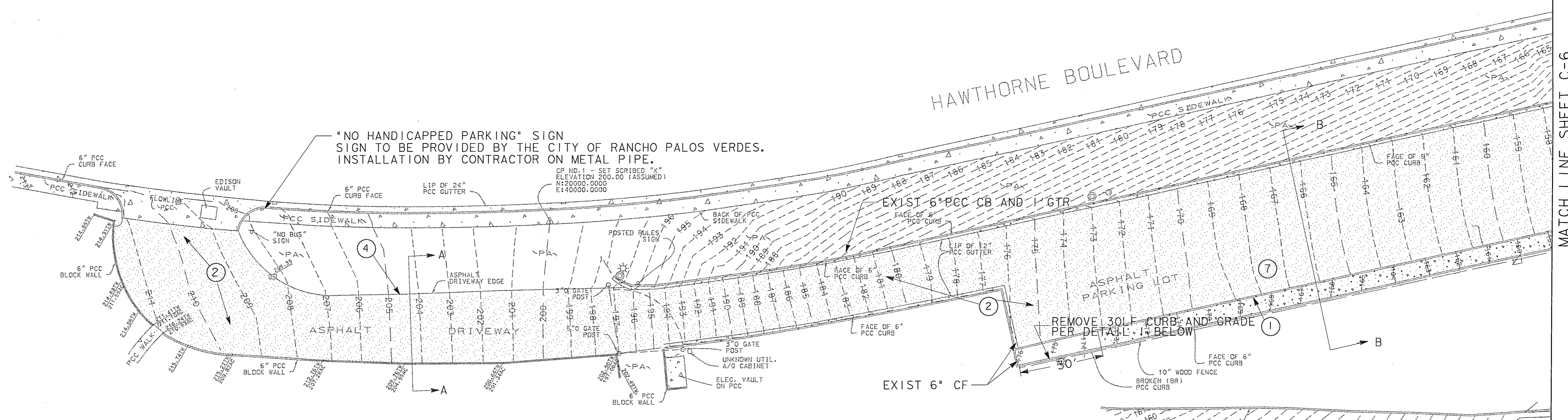

**CONSTRUCTION NOTES SHEETS C-5 & C-6:**

- ① REMOVE AC PVMT AND CONSTRUCT 4-INCH PCC ON NATIVE SOIL.
- ② REPAIR CRACKS, SEAL 2 COATS
- ③ REMOVE EXIST CURB AND CONSTRUCT A1-6 CURB PER APWA STD 120-1.
- ④ CONSTRUCT REDWOOD HEADER PER DETAIL 3, SHEET C-7.
- ⑤ NOT USED
- ⑥ REMOVE EXIST PVMT AND CONSTRUCT 4" AC (2" CLASS C2 ON 2" CLASS B) ON 6" CMB
- ⑦ SINGLE LINE STRIPING, STD 8'-6", 18' LONG  
ALL CURBS SHALL BE REPAINTED AND STENCILED PER EXISTING
- ⑧ REMOVE EXIST PVMT AND CONSTRUCT 3" AC CLASS D1
- ⑨ COLD PLANE EDGES 18" WITH 1/2" WEDGE CUT, RESURFACE WITH 1/2" AC CLASS D1

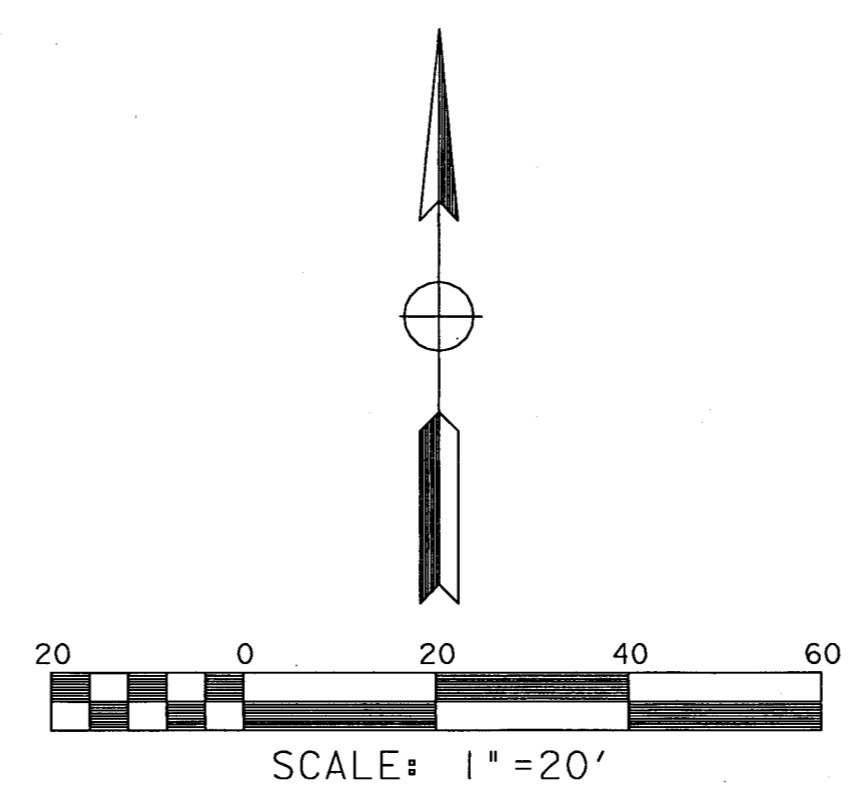

- NOTES:**
- 1. THIS PLAN ACCURATE FOR GRADING AND PAVING PLAN ONLY.
  - 2. PROVISIONS SHALL BE MADE FOR CONTRIBUTORY DRAINAGE AT ALL TIMES.
  - 3. CONTRACTOR MUST SET GRADE STAKES FOR ALL NEW CONSTRUCTION ITEMS SHOWN HEREON.

APPROVED CITY OF RANCHO PALOS VERDES PLANNING DEPARTMENT	APPROVED LOS ANGELES COUNTY FIRE DEPARTMENT	LOS ANGELES COUNTY BUILDING DEPARTMENT
BY _____ DATE _____	BY _____ DATE _____	BY _____ DATE _____
TITLE _____	TITLE _____	TITLE _____

PLANS PREPARED BY  
 JOHN M. CRUIKSHANK DATE 9/30/05  
 CS0792 RCE NO. EXP. DATE  
 JOHN M. CRUIKSHANK CONSULTANTS, INC. (310) 320-8852  
 2341 W. 205TH STREET, STE 103, TORRANCE, CA 90501

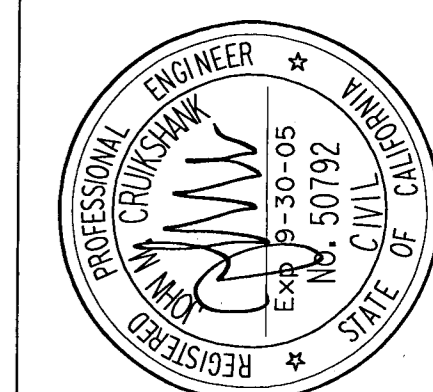

CITY ENGINEER	DEPUTY CITY ENGINEER
ARCHITECT	STRUCTURAL ENG.
	BLOG. MECH. ENG.
	SOILS ENGINEER
<b>RYAN PARK IMPROVEMENTS</b>	
<b>NORTH END OF PARKING LOT</b>	
<b>ROBERT E. RYAN COMMUNITY PARK</b>	
RANCHO PALOS VERDES, CA 90275	
BLDG. NO.	
PROJECT NO.	32714
SCALE	1" = 20'
DATE	10/28/02
JOB CAPTAIN	JCS
DRAWN BY	JCS
CHECKED BY	JMC
SHEET NO.	5
<b>C-5</b>	
OF 7	SHTS

**INDEX NUMBER**

FOR REDUCED PLANS ORIGINAL SCALE IS IN INCHES