

ROBERT E RYAN COMMUNITY PARK RANCHO PALOS VERDES PARK RENOVATION

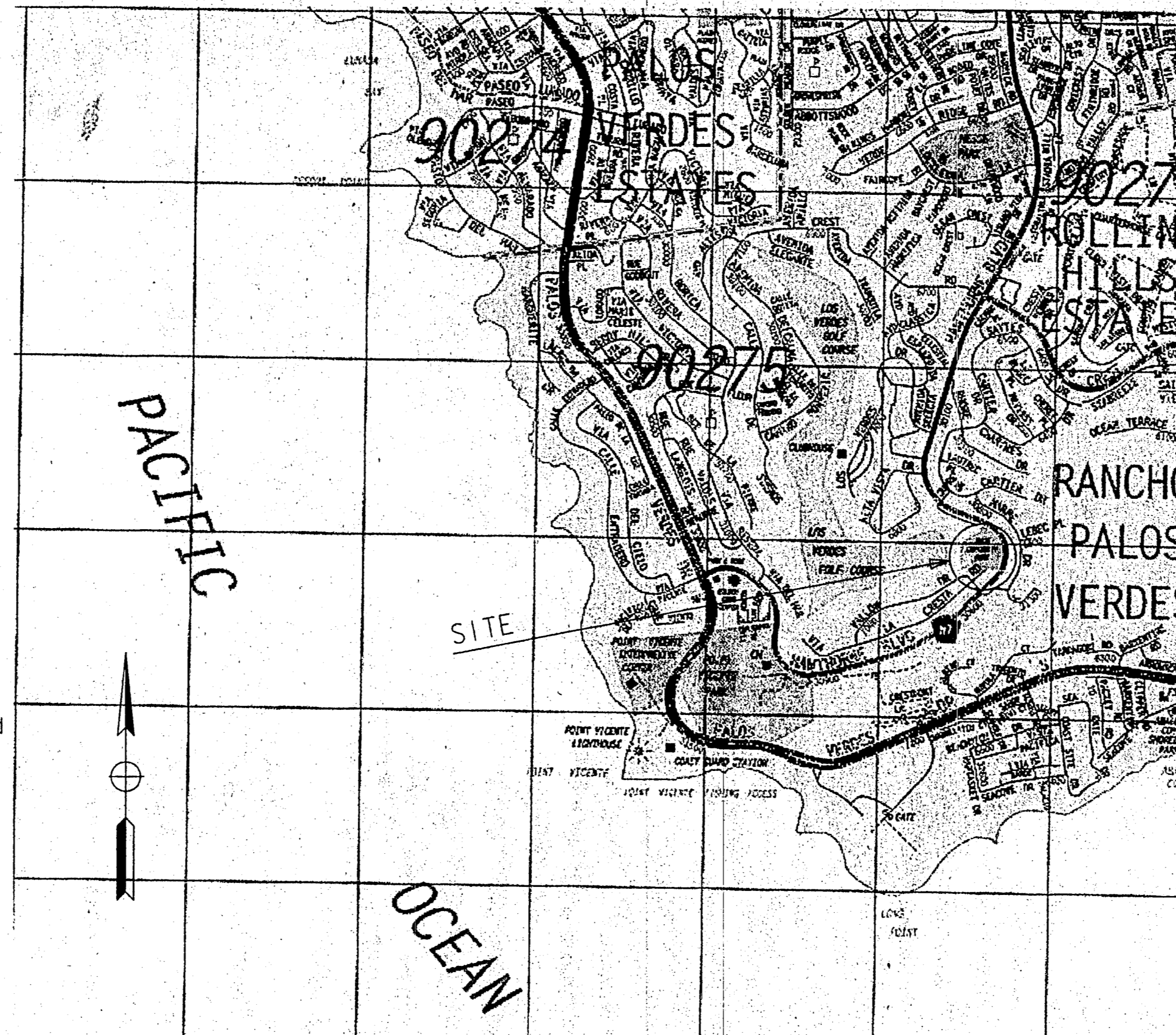

VICINITY MAP
NO SCALE

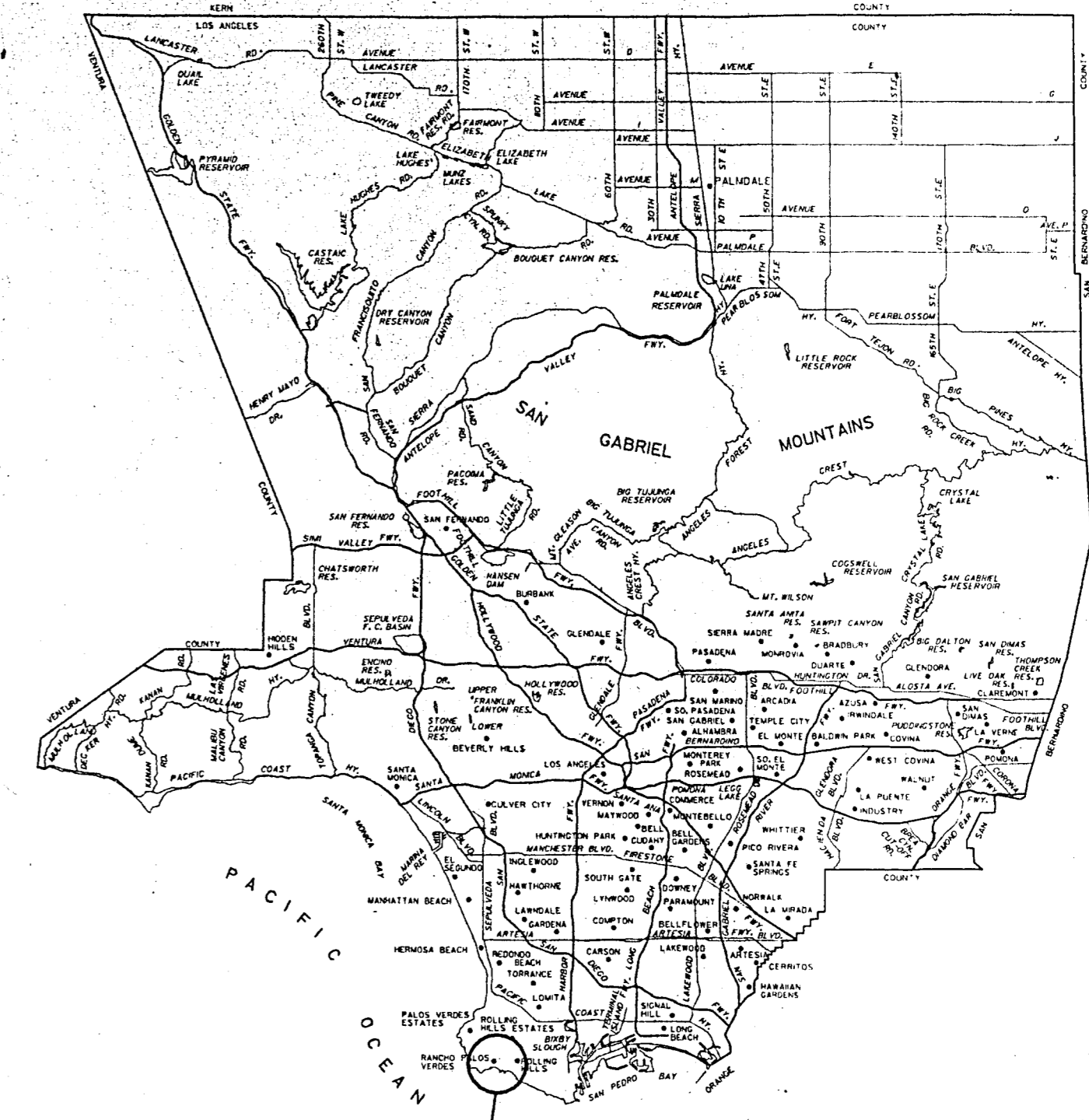

LOCATION MAP

PLANS PREPARED BY

JOHN M. CRUIKSHANK
C50792
RCE NO.

1/4/02
DATE
9/30/05
EXP. DATE

JOHN M. CRUIKSHANK CONSULTANTS, INC. (310) 320-8857
2241 W. 205TH STREET, STE 103, TORRANCE, CA 90501

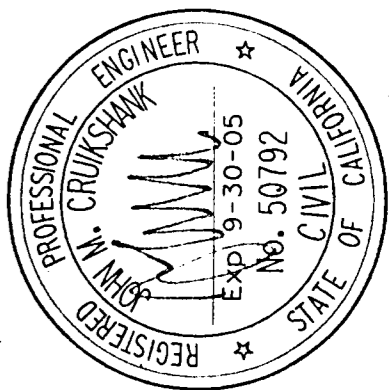

ARCHITECT	CITY ENGINEER
STRUCTURAL ENG.	DEPUTY CITY ENGINEER
B.L.D.G. MECH. ELEC.	CITY ARCHITECT
SOILS ENGINEER	

PARK RENOVATION	
TITLE/NOTE SHEET	
ROBERT E. RYAN COMMUNITY PARK	
RANCHO PALOS VERDES, CA 90275	

PROJECT NO.	32714
SCALE	
DATE	10/10/01
DESIGNED BY	JMC
DRAWN BY	JMC
CHECKED BY	JCS
SHEET NO.	C-1

SHEET 1 OF 4 SHEETS INDEX NUMBER

GENERAL NOTES

- Separate plans for temporary drainage and Storm water Pollution (Erosion Control) measures to be used during the rainy season must be submitted. The erosion control devices shown on said plans must be installed and maintained in operable condition until April 15 of the following year, and before any anticipated rain.
- Every effort should be made to eliminate the discharge of non-storm water from the project site at all times.
- Provisions shall be made for contributory drainage at all times.

GRADING NOTES:

ERODED SEDIMENTS AND OTHER POLLUTANTS MUST BE RETAINED ON SITE AND MAY NOT BE TRANSPORTED FROM THE SITE VIA SHEETFLOW, SWALES, AREA DRAINS, NATURAL DRAINAGE COURSE, OR WIND.

STOCKPILES OF EARTH AND OTHER CONSTRUCTION RELATED MATERIALS MUST BE PROTECTED FROM BEING TRANSPORTED FROM THE SITE BY THE FORCES OF WIND OR WATER.

FUELS, OILS, SOLVENTS, AND OTHER TOXIC MATERIALS MUST BE STORED IN ACCORDANCE WITH THEIR LISTING AND ARE NOT TO CONTAMINATE THE SOIL AND SURFACE WATERS. ALL APPROVED STORAGE CONTAINERS ARE TO BE PROTECTED FROM THE WEATHER. SPILLS MUST BE CLEANED UP IMMEDIATELY AND DISPOSED OF IN A PROPER MANNER. SPILLS MAY NOT BE WASHED INTO THE DRAINAGE SYSTEM.

EXCESS OR WASTE CONCRETE MAY NOT BE WASHED INTO THE PUBLIC WAY OR ANY OTHER DRAINAGE SYSTEM. PROVISIONS SHALL BE MADE TO RETAIN CONCRETE WASTES ON SITE UNTIL THEY CAN BE DISPOSED OF AS SOLID WASTE.

TRASH AND CONSTRUCTION RELATED SOLID WASTES MUST BE DEPOSITED INTO A COVERED RECEPTACLE TO PREVENT CONTAMINATION OF RAINWATER AND DISPERSAL BY WIND.

SEDIMENTS AND OTHER MATERIALS MAY NOT BE TRACKED FROM THE SITE BY VEHICLE TRAFFIC. THE CONSTRUCTION ENTRANCE ROADWAYS MUST BE STABILIZED SO AS TO INHIBIT SEDIMENTS FROM BEING DEPOSITED INTO THE PUBLIC WAY. ACCIDENTAL DEPOSITIONS MUST BE SWEEPED UP IMMEDIATELY AND MAY NOT BE WASHED DOWN BY RAIN OR OTHER MEANS.

ANY SLOPES WITH DISTURBED SOILS OR DENUDED OF VEGETATION MUST BE STABILIZED SO AS TO INHIBIT EROSION BY WIND AND WATER.

The following Best Management Practices (BMP) as outlined in, but not limited to, the BMP Handbook, California Stormwater Quality Task Force, Sacramento, California 1993, or the latest revised edition, apply during construction:

- | | |
|---|---|
| CA002-PAVING OPERATIONS | CA022-CONTAMINATED SOIL MANAGEMENT |
| CA010-MATERIAL DELIVERY AND STORAGE | CA023-CONCRETE WASTE MANAGEMENT |
| CA011-MATERIAL USE | CA024-SANITARY/SEPTIC WASTE MANAGEMENT |
| CA012-SPILL PREVENTION AND CONTROL | CA030-VEHICLE AND EQUIPMENT CLEANING |
| CA020-SOLID WASTE MANAGEMENT | CA031-VEHICLE AND EQUIPMENT FUELING |
| CA021-HAZARDOUS WASTE MANAGEMENT | CA032-VEHICLE AND EQUIPMENT MAINTENANCE |
| ESCO1-SCHEDULING | ESC52-SAND BAG BARRIER |
| ESCO2-PRESERVATION OF EXISTING VEGETATION | |
| ESC21-DUST CONTROLS | |
| ESC24-STABILIZED CONSTRUCTION ENTRANCE | |

BENCH MARK

BENCH MARK:
CP NO. 1 - SET SCRIBED "X" ALONG
HAWTHORNE BLVD., LOCATION ON C-2
ELEVATION=200.00 (ASSUMED)
N+ 20000.0000
E+ 40000.0000