

**Above Ground Structures** 40' or no closer than northern perimeter road.  
**Ground Burials** 16' setback to North R. except 13 interments in NW corner and 6 plots already sold

**Above Ground Structures** 80' setback or no closer than northern perimeter road  
**Ground Burials** 8' setback to North R.

**Pacifica Mausoleum**  
• 15' to West R. for existing building.  
• 5' for northwest addition

**Above Ground Structures** 5'  
**Ground Burials** 0'

**Above Ground Structures** 25'  
**Ground Burials** 0'

**Above Ground Structures** 40'  
**Ground Burials** 8'

**THIS SHEET HAS BEEN UPDATED PER PLANNING COMMISSION ADOPTED RESOLUTION NO. 2015-09, CONDITION OF APPROVAL 1.2(m)**

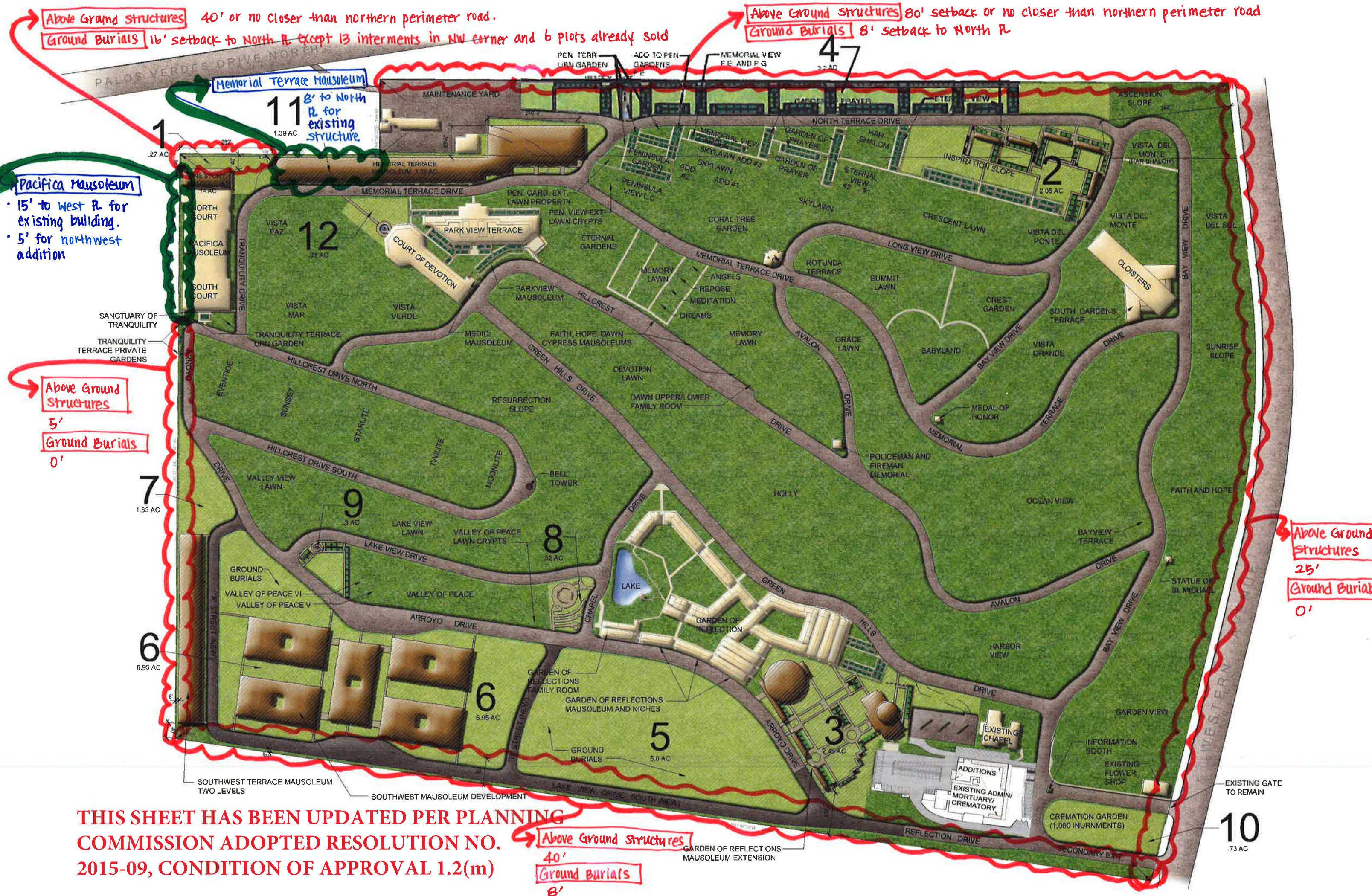

10  
.73 AC